

OPERATING INSTRUCTIONS

Williams Sonoma Cantilever umbrella

- ① Remove all packaging from umbrella, including inside the umbrella.
- ② Pull pin to unlock cam lock handle. Make sure cam lock handle is open per drawing shown.
- ③ Insert cover on to mast.
Place Umbrella on SECURITY STEM.
- ④ Push cam lock handle (per drawing shown) until engaged in the proper gear slot with the cam lock handle in the downward position.

** To rotate umbrella: Pull pin to unlock cam lock handle, pull up and turn umbrella to desired location. Lock cam lock handle down.*

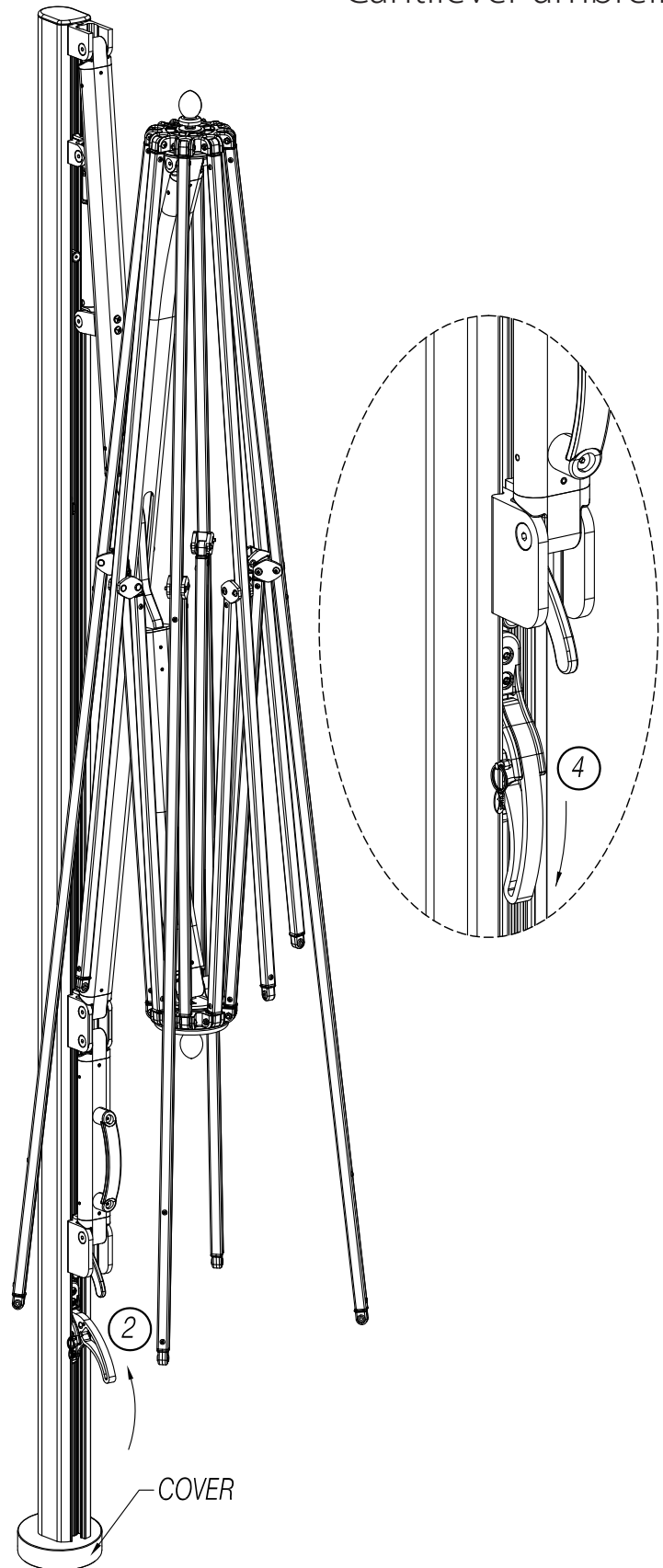
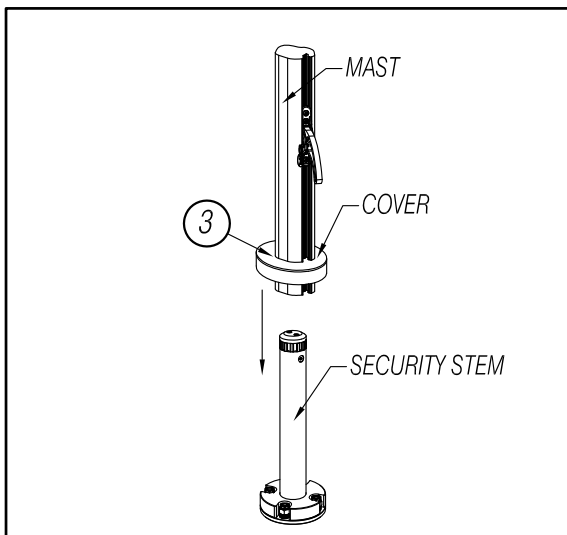
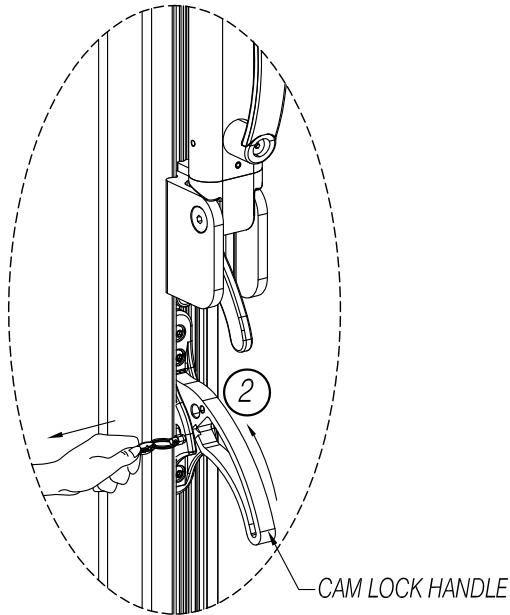

OPERATING INSTRUCTIONS

Williams Sonoma Cantilever umbrella

- ⑤ Gently separate EACH RIB INDIVIDUALLY from center hub, approx. 24-36"/60-90Cm. If rib does not move easily, DO NOT force. Inspect product for additional packaging.
- ⑥ Push up Cart Handle to stopper until the cart is locked as per drawing show.

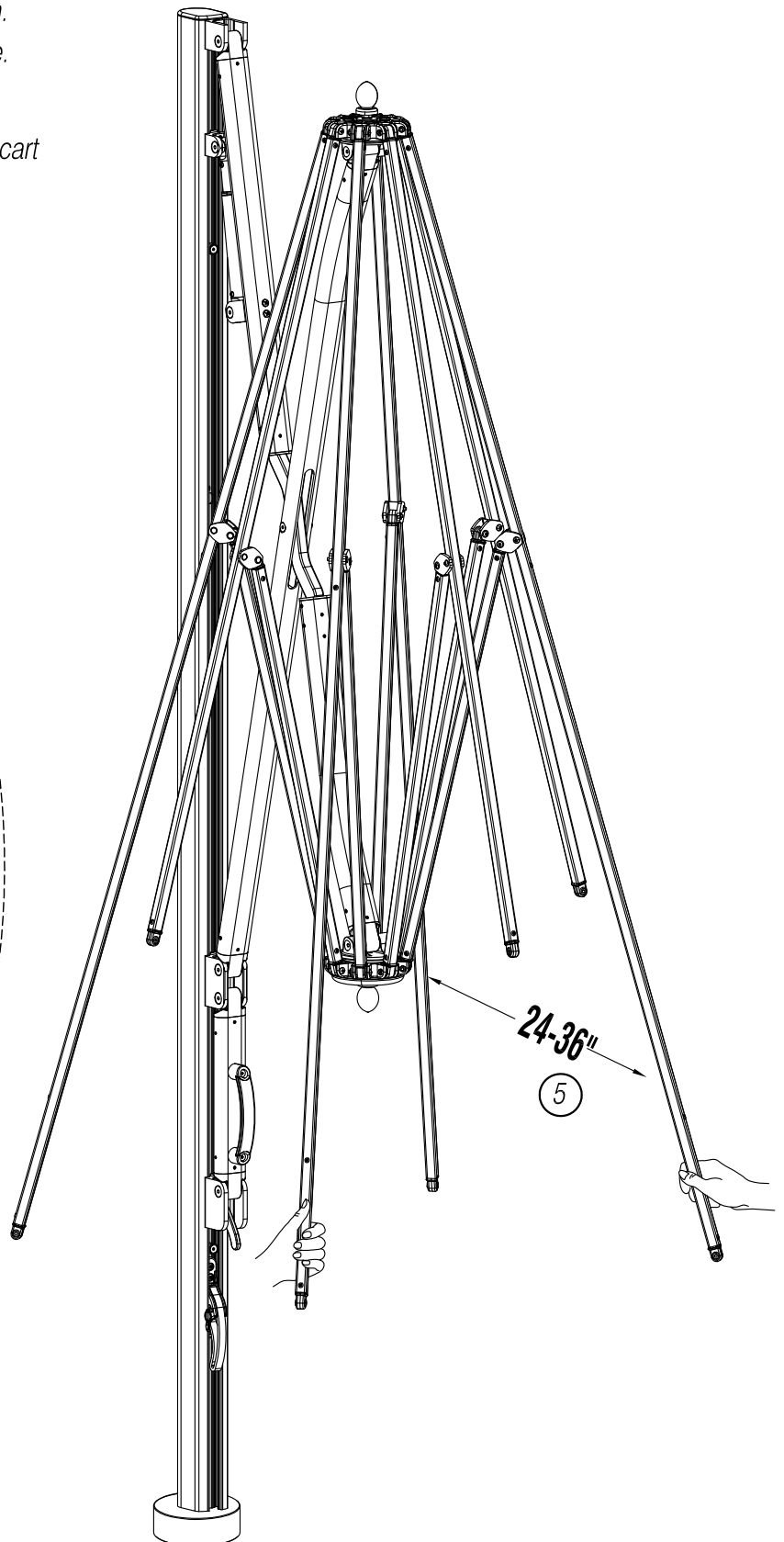
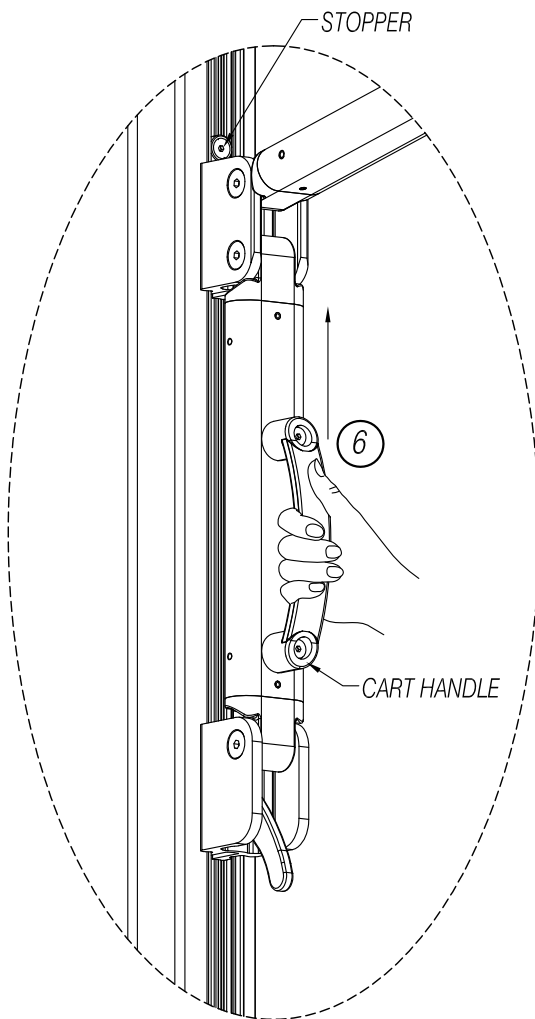

OPERATING INSTRUCTIONS

Williams Sonoma Cantilever umbrella

- ⑦ Hold Cart Handle by hand then push down cart lock and slide Cart Handle down to close umbrella. Close umbrella during wind conditions that exceed manufacturer's specifications.
- ⑧ Close umbrella with tie back when not in use.

