

WILLIAMS SONOMA Bluetooth Thermometer

Quick Start Guide

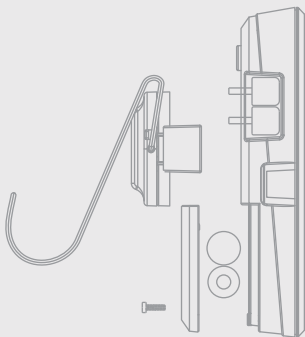

Step 1: Unscrew the battery cover and install the batteries. The unit will beep and then turn off the unit.

WILLIAMS SONOMA Bluetooth Thermometer

Quick Start Guide



Step 2: Go to the Apple App Store or the Google Play Store. Type in the app "BT-600WS" and download the app to your smart phone or tablet. Turn on the thermometer with the power button. Make sure that the blue light on the front of the unit is blinking. If not blinking press the Bluetooth button on the back of the thermometer.

WILLIAMS SONOMA Bluetooth Thermometer

Quick Start Guide

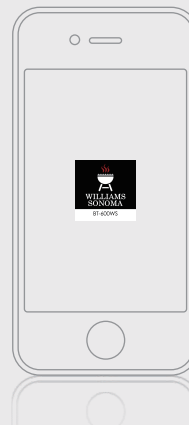

Step 3: Click the installed App and follow the on-screen instructions to turn on the Bluetooth of your smart device. The first page is the pairing page and the app will show up as the first item on the list. Click on that and the unit will activate.

WILLIAMS SONOMA Bluetooth Thermometer

Quick Start Guide

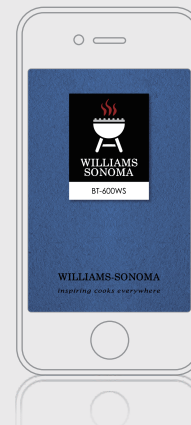

Step 4: By pressing the picture of the meat on the display you can select the meat and meat taste of on the app and start to cook. Once you have selected the meat and taste options, press the button "OK" and it will set the thermometer.
Step 5: When finished cooking turn off the unit by pressing and holding the ON/OFF button on the back of the device for 3 seconds.

WILLIAMS SONOMA
Bluetooth Thermometer

Temperature Mode

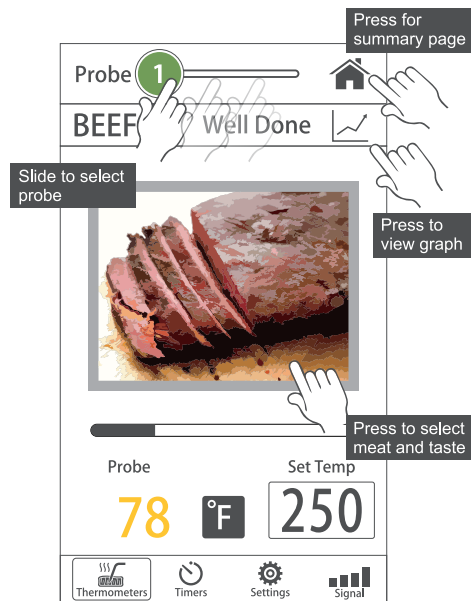

WILLIAMS SONOMA
Bluetooth Thermometer

Select Meat & Taste

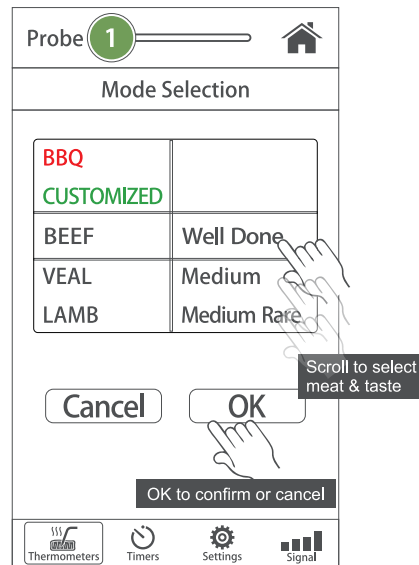

WILLIAMS SONOMA
Bluetooth Thermometer

Timer Mode

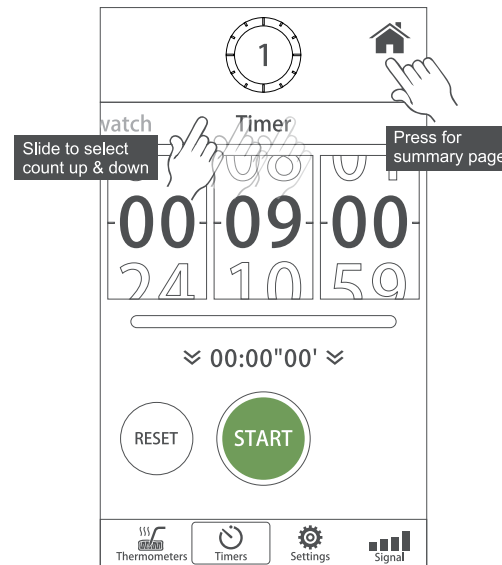

WILLIAMS SONOMA
Bluetooth Thermometer

Supporting information

Supporting operation systems

- iOS 6 or above
- Android 4.3 or above with Bluetooth 4.0

For recommended smart devices please refer to the latest list on Google Play or Apple App Store.

Learn More

A full version of user manual is available inside the "Setting" page on the APP.

Need more help?

Email us at help@maverickhousewares.com