

**ADS-A02U**

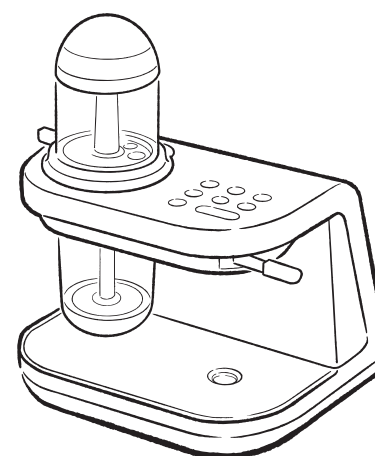

**For technical questions and support, please contact:**

**Tiger Corporation U.S.A.**

1815 W 205th Street, Unit 106, Torrance CA 90501

Tel: 1-866-55-TIGER (84437)

Email: [support@japantigercorp.com](mailto:support@japantigercorp.com)

URL: <https://tiger-corporation-us.com/>

For customers outside the continental U.S., please contact the nearest Tiger Customer Service in your area, or the dealer where the original purchase was made.



**TIGER CORPORATION**

Head Office: 3-1 Hayami-cho, Kadoma City, Osaka 571-8571, Japan

URL: <https://www.tiger.jp/global/>

For household use

**Electric Coffee Maker**

**Instruction Manual**

Thank you for purchasing this product. Please read all information in this manual before using the appliance.

Afterward, keep this manual in a handy location for future reference by anyone who will use this product.

# IMPORTANT SAFEGUARDS

When using the appliance, basic safety precautions should always be followed including the following:

1. Read all instructions.
2. Do not touch hot surfaces. Use handles or knobs.
3. To protect against fire, electric shock and injury to persons do not immerse cord, plugs, or appliance in water or other liquid.
4. Close supervision is necessary when any appliance is used by or near children.
5. Unplug from outlet when not in use and before cleaning. Allow to cool before putting on or taking off parts, and before cleaning the appliance.
6. Do not operate any appliance with a damaged cord or plug or after the appliance malfunctions, or has been damaged in any manner. Return appliance to the nearest authorized service facility for examination, repair or adjustment.
7. The use of accessory attachments not recommended by the appliance manufacturer may result in fire, electric shock or injury to persons.
8. Do not use outdoors.
9. Do not let cord hang over edge of table or counter, or touch hot surfaces.
10. Do not place on or near a hot gas or electric burner, or in a heated oven.
11. Always attach plug to appliance first, then plug cord into the wall outlet.  
To disconnect, turn any control to "off", then remove plug from wall outlet.
12. Do not use the appliance for other than intended use.
13. Securely attach the lid, upper cylinder, joint, and lower cylinder.  
Otherwise, these parts may come off when the product is lifted up, causing burns or injuries.
14. Scalding may occur if the lid is removed during the brewing cycles.

## 15. SAVE THESE INSTRUCTIONS.

Servicing should be performed by an authorized service representative.  
This appliance is intended for household use.

To reduce the risk of injury, do not drape cord over the counter top or table top where it can be pulled on by children or tripped over unintentionally.

The appliance is not intended for use by persons (including children) with reduced physical, sensory or mental capabilities, or lack of experience and knowledge, unless they have been given supervision or instruction concerning use of the appliance by a person responsible for their safety.

Children should be supervised to ensure that they do not play with the appliance.

The following instructions are applicable to 120V only:

This appliance has a polarized plug (one blade is wider than the other). To reduce the risk of electric shock, this plug is intended to fit into a polarized outlet only one way. If the plug does not fit fully into the outlet, reverse the plug. If it still does not fit, contact a qualified electrician. Do not attempt to modify the plug in any way.

## Table of Contents

### Introduction

#### 4 - Important Safeguards

9 - Names of Component Parts  
and Accessories

10 - Attaching and Removing Parts

### How to Use

11 - When Using the Appliance for  
the First Time or after a Long Time  
without Use

12 - Making Coffee

### How to Clean

16 - How to Clean

17 - How to Attach the Gaskets

18 - How to clean the path inside  
the main unit

### Troubleshooting

20 - Troubleshooting

21 - Error displays and actions to be taken

### Others

22 - Specifications

22 - Purchase of consumables and options

# Important Safeguards

Read the following instructions carefully before use and be sure to observe them.

- The precautions described below are intended to protect the user and other individuals from physical harm and to safeguard against damage to property. Be sure to follow these instructions since they are important safeguards.
- Do not remove the safety instruction seals attached to the main unit.

Safety instructions are classified and described as shown below, according to the level of harm and damage caused by improper use or ignoring instructions.



**Warning** This indicates that there is a possibility of death or serious injury\*<sup>1</sup> when the unit is improperly handled by the user.



**Caution** This indicates that there is a possibility of injury\*<sup>2</sup> or damage to property\*<sup>3</sup> when the unit is improperly handled by the user.

\*1 Serious injury is defined here as a medical condition such as loss of sight, injuries, burns (high-temperature or low-temperature burns), electric shocks, broken bones, or poisoning which will have aftereffects and/or which will require hospitalization or long-term outpatient care.

\*2 Injury is defined here as physical injuries, burns or electric shock which will not require hospitalization or long-term outpatient care.

\*3 Damage to property is defined here as damage extending to buildings, household effects, domestic animals, pets, etc.

## Meaning of each symbol



The symbol indicates a warning or caution. The specific details of the warning or caution are indicated inside the symbol or in a picture or text near the symbol.



The symbol indicates a prohibited action. The specific details of the prohibited action are indicated inside the symbol or in a picture or text near the symbol.



The symbol indicates an action or instruction to be taken. The specific details of the action or instruction are indicated inside the symbol or in a picture or text near the symbol.



## Warning Extra attention required for infants or toddlers



**Do not allow children to use the appliance by themselves, and do not use the appliance in areas within the reach of infants or toddlers.**

This is to avoid burns, electric shock, or injuries.



Do not touch

**Do not touch or bring your face or other body parts close to the parts that are hot during use and immediately after use (the steam vent, lid, upper cylinder, lower cylinder, spout, etc.).**

This is to avoid burns.

Never allow infants or toddlers to touch these parts.

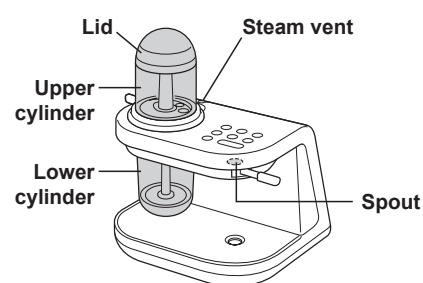

## Warning

### Modification is prohibited



Disassembly is prohibited

**Do not attempt to disassemble, repair, or modify the product unless you are a repair engineer.**

This is to avoid electric shock or injuries. Failure to observe this precaution may result in a fire. Contact TIGER CORPORATION U.S.A for inspection and repair.



## Warning

### In case of trouble



**In case of trouble, immediately unplug the plug and contact TIGER CORPORATION U.S.A. to request repair.**

Continued use may result in electrical shock or injury. Failure to observe this precaution may result in a fire.

#### Examples of trouble:

- The power cord and plug become abnormally hot during use.
- When the power cord is bent, power supply becomes unstable.
- Water leaks from the upper cylinder, lower cylinder, or main unit.
- Other troubles.



## Caution

### While in use or after use



**Do not knock over, drop, strike, or expose the product to excessive shocks.**

Doing so may result in injuries due to damage to parts such as the main unit, filter, upper cylinder, lid, and lower cylinder or may cause a malfunction.



**Do not remove the lid or touch the lock bar or pouring bar during coffee extraction.**

Doing so may result in burns and/or spillage.



**Do not move the main unit while it is holding a cup.**

Doing so may result in burns or injuries.



**Do not use superfine coffee grounds.**

Doing so may clog the filter, preventing this product from finishing operating normally.



**Do not use this product with the tray or tray cover removed.**

Doing so may result in burns and/or spillage.



**If you hear one continuous beep, three short beeps, and then 16 short beeps during coffee extraction and the product stops, do not touch the main unit until it cools down (wait approximately 10 minutes).**

Steam or hot water may spray out, resulting in burns.



**After coffee extraction, do not pull the pouring bar until you set a mug or something similar under the spout.**

Doing so may result in burns.



**Securely attach the lid, upper cylinder, joint, and lower cylinder.**

Otherwise, these parts may come off when the product is lifted up, causing burns or injuries.



**Wait (approximately 10 minutes) until the main unit cools down before using this product again.**

Pouring water into or moving this product immediately after use may cause steam to spray out, resulting in burns.



**Cleaning can only be done after the main unit has cooled down (wait approximately 10 minutes).**

This is to avoid burns caused by touching hot surfaces (the steam vent, lid, upper cylinder, lower cylinder, spout, etc.).

## Important Safeguards

### Safety instructions to follow so that the appliance can be used for many years

- **Clean the parts listed under “Parts to wash after every use → P. 16” after every use.**  
Failure to do so may cause unpleasant odors.
- **Discard the water collected in the tray after every use.**  
Failure to do so may cause unpleasant odors and/or spillage.
- **Do not put the appliance in a dishwasher/dryer or dish dryer. (This does not apply to the lid, upper cylinder, lower cylinder, and water pumping pipe.)**  
Regarding the parts that can be used with a dishwasher/dryer or dish dryer, follow the instructions given under “Using a dishwasher/dryer or dish dryer (lid, upper cylinder, lower cylinder, and water pumping pipe only)” → P. 17.
- **Do not wash this appliance with boiling water. (This does not apply to the upper cylinder gasket, joint gasket, and water pumping pipe gasket.)**  
Doing so may result in deformation or breakage.
- **If mineral water or alkali ion water is used, clean the appliance even more frequently.**  
Failure to do so may lead to longer coffee extraction times due to calcium build up inside the main unit.  
Also, calcium built up on the inside surfaces may clog the hot water spout and/or the steam vent inside the main unit, causing a malfunction.
- **Do not use this product for other than in-home use.**  
Doing so may cause a malfunction.
- **After use, wash out the path inside the main unit with hot water. → P. 18**  
Failure to do so may cause unpleasant odors.



## Caution

### Caution on the areas of use



#### Do not use the appliance in the following areas:

- On an unstable surface
- Near an open flame
- In areas prone to getting wet
- In areas that allow the bottom of the main unit to get wet
- In areas exposed to direct sunlight for a prolonged period
- Near a wall or furniture
- On a table or rug that is vulnerable to heat
- On an aluminum sheet or electric mat
- On a carpet or plastic bag
- In areas with a high room temperature
- On an induction cooktop
- Outdoors

This precaution is to avoid electric shock, electric leakage, or injuries. Use in places as shown above may cause a fire, short circuit, smoke, ignition, or malfunction.  
It may also cause the main unit and/or nearby areas to become deformed or discolored.



#### If using a kitchen storage rack (a sliding tabletop), note the following instructions.

- Be sure that steam does not stay inside.
- Be sure that the operation panel is not exposed to a large amount of steam.
- Be sure that the plug is not exposed to steam.
- Pull the sliding tabletop out so it is not exposed to steam.
- Before use, check the weight limit of the area where the appliance is placed.

This is to avoid electric shock, burns, or injuries.  
Failure to follow these instructions may result in a fire, ignition, damage, discoloration, deformation, or malfunction.

## Precautions on each part

### Power cord and plug



## Warning



#### Do not use the appliance in the following ways:

- Use outside 120 VAC.
- Use with an outlet connected with multiple plugs.  
(Be sure to use an outlet rated at 15 A or higher exclusively for the appliance.)
- Use that may damage the power cord or use while this cord is damaged. (For example, the power cord must not be modified, bent forcibly, placed near a high temperature area, pulled, twisted, bundled, placed under a heavy object, dangled from the edge of a desk, or tucked.)
- Use while the plug has dust adhering to it or is damaged.
- Use with the plug not completely plugged to an outlet.
- Plugging and unplugging with wet hands.
- Use while the appliance is wet (soaked in water or with water poured on it).
- Disconnecting the plug during coffee extraction.



Do not touch the unit with wet hands



This precaution is to avoid electric shock, electric leakage, or injuries. Usage as shown above may cause a fire, short circuit, smoke, ignition, or malfunction.

In the case of breakage, immediately disconnect the power plug from the outlet and contact TIGER CORPORATION U.S.A. for inspection and repair.

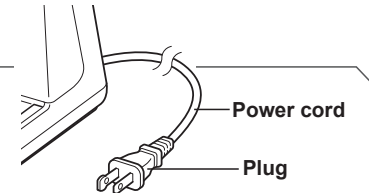

## Caution



- **Disconnect the plug before cleaning and leave unplugged when not in use.**
- **Be sure to grip the plug when removing the power cord.**



Unplug the power cord

This is to avoid burns or injuries. Failure to do so may cause an electric shock, short circuit, or ignition; fire due to a short circuit; or damage to a nearby wall or furniture.

### Main unit



## Warning



#### Do not soak this appliance in water or pour water on it.

- Do not wash the entire appliance.
  - Do not pour water into the main unit.
- Otherwise, water may get into the main unit and cause an electric shock.  
This is to avoid short circuits, malfunctions, or fire.

Never immerse the unit in water or other liquid

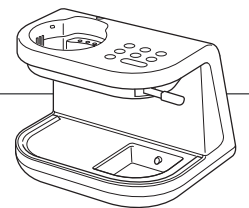

## Caution



#### Do not lean on or otherwise apply your body weight to the main unit.

Applying your center of gravity to the front of the appliance may result in deformation, damage, or a malfunction.  
It may also result in injuries due to the main unit falling over.



## Precautions on each part

### Lid/Upper cylinder/Joint

#### Caution

**Do not start coffee extraction with no water in the upper cylinder.**  
Doing so may result in fire or a malfunction.

**Do not remove the upper cylinder or lid during coffee extraction.**  
Doing so may result in burns, water leakage, or a malfunction.

**Do not forcefully pull on the large and small lower gaskets attached to the upper cylinder.** → P. 17  
Doing so may cause a malfunction.

**Do not forcefully pull on the small gaskets (in eight locations) attached to the joint.** → P. 17  
Doing so may cause a malfunction.

**Wait for the upper cylinder to cool down (wait approximately 10 minutes) before removing it after coffee extraction.**  
Failure to do so may result in burns.

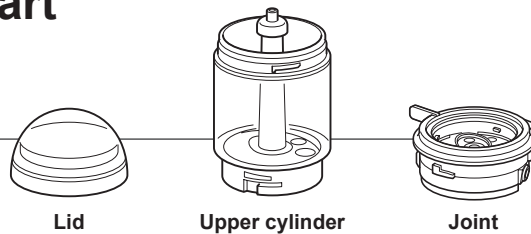

#### Safety instructions to follow so that the appliance can be used for many years

**Do not use this product with less water than the minimum amount (the one cup water level). Also, do not insert more water than the maximum amount (the two cup water level).**

**Do not leave water or coffee in the upper cylinder or tray.**  
Doing so may cause a malfunction, discoloration, unpleasant odors, or spoilage.

**Do not start coffee extraction with anything other than water in the upper cylinder.**  
Doing so may cause a malfunction.

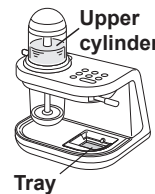

### Tray and tray cover

#### Caution

**Do not use this product with the tray or tray cover removed.**  
Doing so may result in burns and/or spillage.

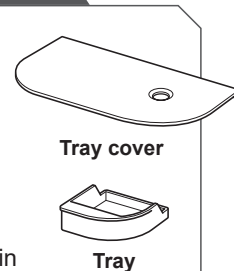

### Lower cylinder

#### Caution

**Do not extract coffee with the lower cylinder removed.**  
Doing so may cause hot water to splash out, resulting in burns.

**Wait for the lower cylinder to cool down (wait approximately 10 minutes) before removing it after coffee extraction.**  
Failure to do so may result in burns.



### Filter

#### Caution

**Do not forcefully pull on the filter gasket.** → P. 17  
Doing so may cause a malfunction.



### Gaskets

#### Caution

**Be sure to set the upper cylinder gasket, joint gasket, and water pumping pipe gasket in place before use.**  
Failure to do so may result in burns, water or steam leakage, defective operation, or a malfunction.

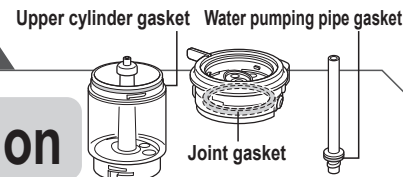

## Names of Component Parts and Accessories

Check each part first after unpacking the product.

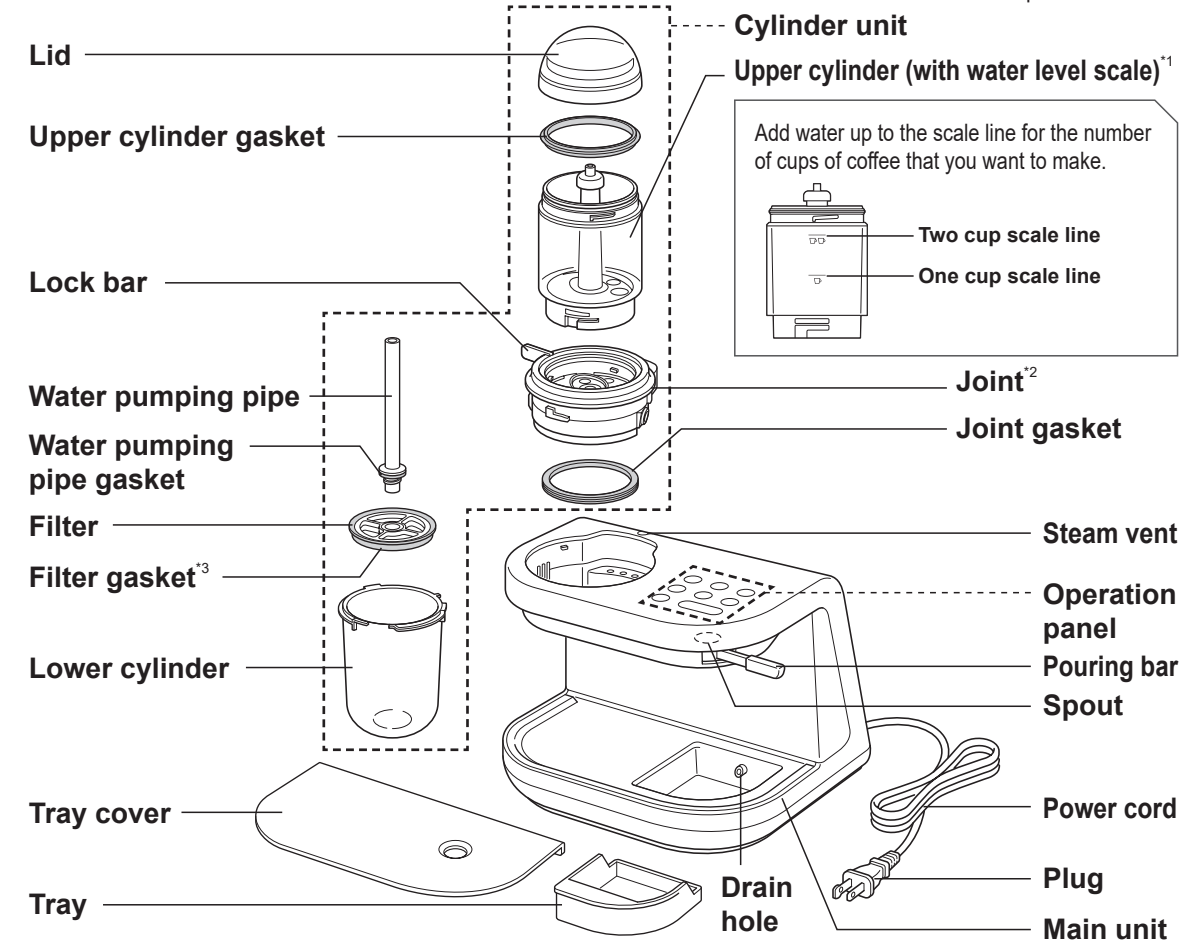

\*1: The large bottom gasket and small bottom gasket cannot be removed. → P. 17

\*2: The small gaskets (in eight locations) cannot be removed. → P. 17

\*3: The filter gasket cannot be removed. → P. 17

### Operation panel

#### Flavor selection keys

Three stages from [Acidic] to [Bitter]

Acidic

Bitter

Light

Strong

Dual Temp

Start | Stop

#### Strength selection keys

Three stages from [Light] to [Strong]

**[Start|Stop] key**  
Starts and stops coffee extraction.

#### [Dual Temp] key

Extracts coffee using a special method that switches from high temperature to low temperature. It can also be used to set the operating sound when a menu setting is selected. → P. 11

### Checking the accessories

Measuring spoon: 1

One level spoonful = Approx. 10 g

Pipe cleaning brush: 1

Cylinder stand: 1

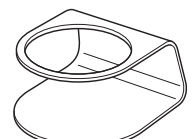

# Attaching and Removing Parts

## Removing the cylinder unit

◇ Installing the cylinder unit → P. 14

- 1 Turn the lock bar in the direction of the arrow.

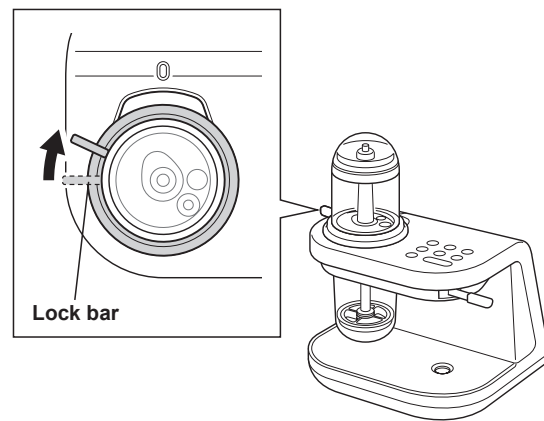

- 2 Remove the cylinder unit.

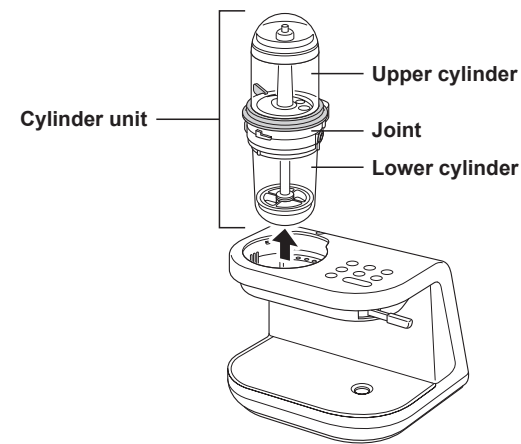

## Attaching and removing the lower cylinder

<Removing>

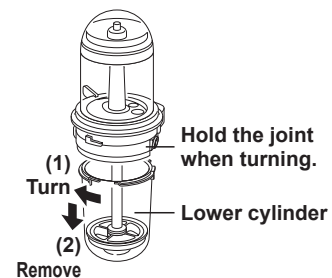

<Attaching>

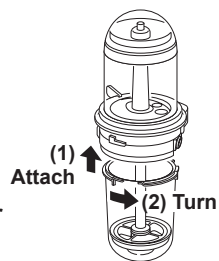

### ⚠ Caution

- Be sure to hold the joint when turning. Failure to do so may result in a part falling off and becoming damaged.

## Attaching and removing the water pumping pipe

<Removing>

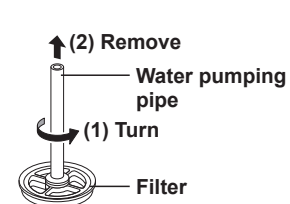

<Attaching>

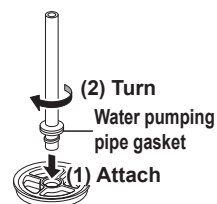

# When Using the Appliance for the First Time or after a Long Time without Use

- 1 Wash all parts other than the main unit. → P. 16

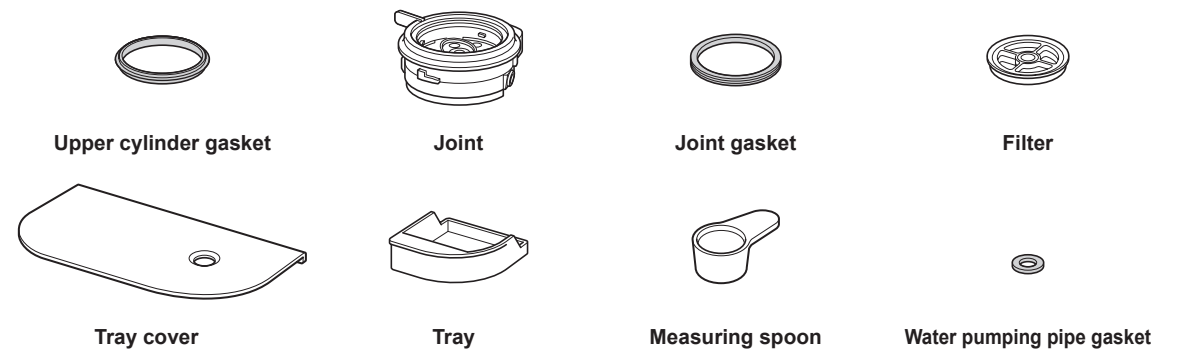

A dishwasher/dryer or dish dryer can be used for the following parts.

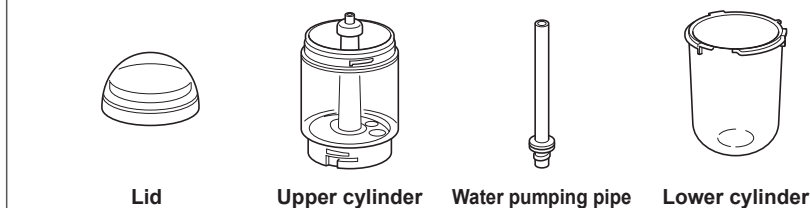

- 2 Rinse the path inside the main unit with hot water. → P. 18

◇ Cleaning can also be performed using citric acid. (Removing mineral components from the path inside the main unit → P. 18)

### ⚠ Caution

- Do not add water to any part other than the upper cylinder.
- Do not use a mug made of a material that is easily affected by heat. (It must be heat resistant to 120°C or higher.) There is the risk of deformation.
- Securely set the tray, tray cover, and mug or similar cup in place. There is the risk that hot water may overflow and cause burns.
- Depending on the shape of the mug or similar cup and the position where it is placed, there is the risk that hot water may splash out.

## Muting the operation sound

If the operating sound that occurs when a menu setting is selected is disturbing to you, you can mute it.

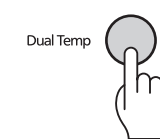

**Press and hold the [Dual Temp] key for three seconds or longer.**

◇ Press and hold for three seconds or longer again to restore the operation sound.

# Making Coffee

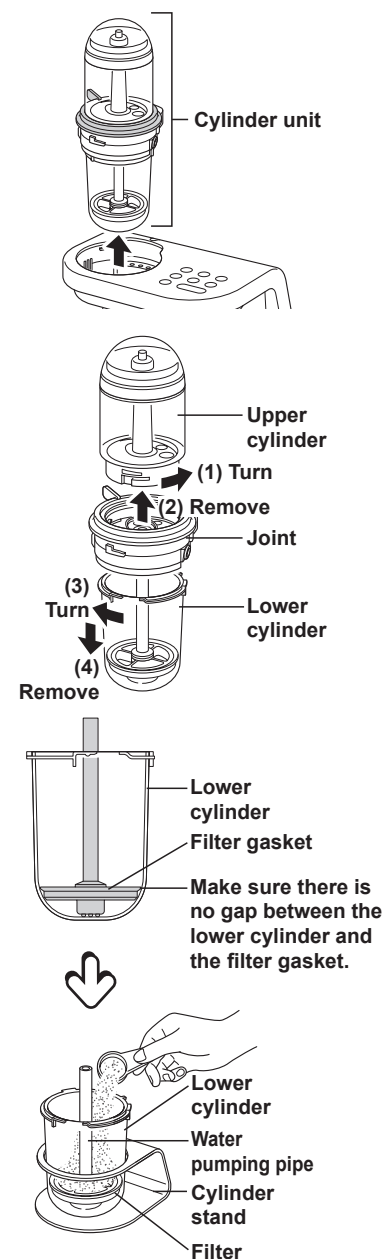

## 1 Remove the cylinder unit from the main unit.

◇ Removing the cylinder unit → P. 10

## 2 Remove the upper cylinder and lower cylinder from the joint.

◇ Be sure to hold the joint when turning the cylinders.

## 3 Use the provided measuring spoon to add coffee grounds on top of the filter and smooth out the top.

◇ Because the bottom of the lower cylinder is unstable, place it into the provided cylinder stand.

### ⚠ Caution

- Do not add coffee grounds before installing the filter into the lower cylinder. Also do not add coffee grounds into the water pumping pipe. Doing so may cause coffee grounds to enter the main unit, preventing operation from completing normally.
- Check that the water pumping pipe gasket is attached to the water pumping pipe. → P. 10, 17
- Check that the water pumping pipe and filter are installed in the lower cylinder.
- Install the water pumping pipe and filter so they are straight, and make sure there is no gap between the lower cylinder and the filter gasket. If there is a gap, the coffee grounds may fall through it.

### <Guidelines for adding coffee grounds>

Amount extracted	Coffee grounds (level measuring spoons)	Water level scale
240 mL	Two spoonfuls	
120 mL	One spoonful	
120 mL(for iced coffee)	Two spoonfuls	

- Adjust the amount of coffee grounds according to your preference.
- When using Dual Temp, it is recommended that you extract 240 mL.
- Because there is the risk of overflowing, do not add more than two level measuring spoons.
- When you will add ice to make iced coffee after extracting the coffee, it is recommended that you use coffee grounds that are marketed specifically for iced coffee.

### ⚠ Caution

- Do not use superfine coffee grounds. Use medium-fine or larger coffee grounds. Superfine coffee grounds may clog the filter, preventing operation from completing normally.

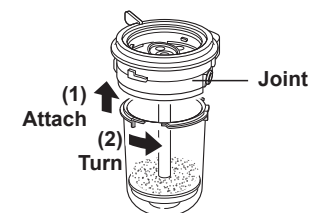

## 4 Attach the lower cylinder to the joint.

◇ Attaching the lower cylinder → P. 10

### ⚠ Caution

- Check that the joint gasket is attached. If it is not, there is the risk of burns.

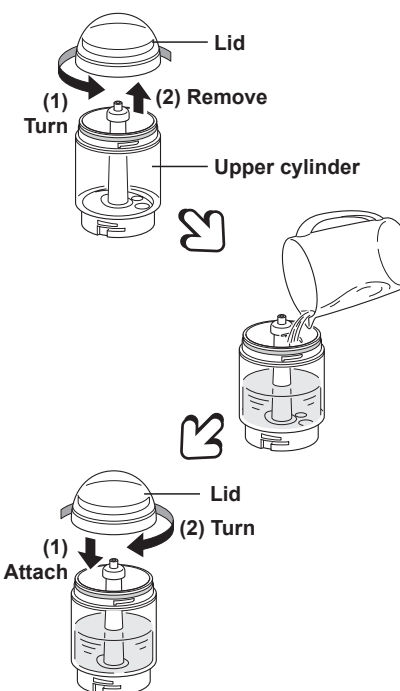

## 5 Add water to the upper cylinder.

- Add water up to the scale line for the amount of coffee that you want to make. → P. 12
- Do not add water to above the two cup scale line. Doing so may cause coffee to overflow.
- Add water to at least the one cup scale line. If the amount of water is too little, extraction will end without the coffee being extracted into the upper cylinder.

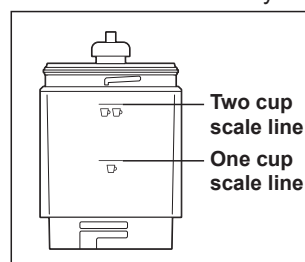

### ⚠ Caution

- Add cold water to the upper cylinder. Adding hot water or warm water when extracting coffee may result in malfunction.
- Check that the upper cylinder gasket is attached. If it is not, there is the risk of burns.

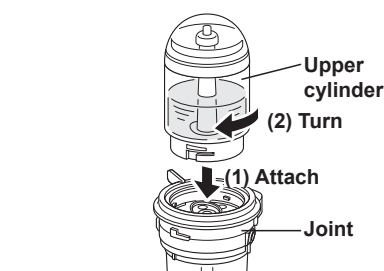

## 6 Attach the upper cylinder to the joint.

◇ Attaching the upper cylinder → P. 10

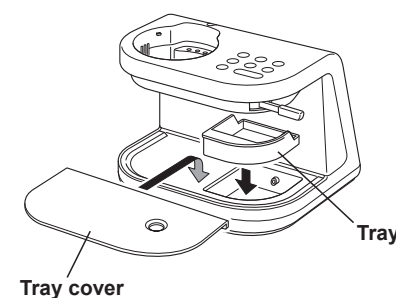

## 7 Install the tray and tray cover onto the main unit.



## Making Coffee

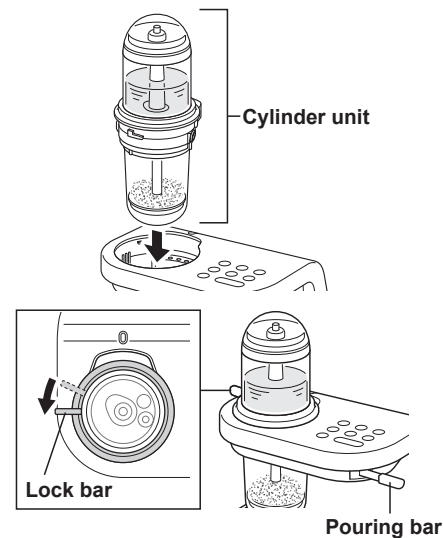

### 8 Install the cylinder unit onto the main unit.

#### ⚠ Caution

- When installing, be careful not to turn the upper cylinder. If the upper cylinder is turned, the lock bar will not turn in step 9.

### 9 Turn the lock bar in the direction of the arrow to lock the cylinder in place.

#### ⚠ Caution

- When locking, be careful not to pull the pouring bar toward you. Water may come out from the spout, causing spillage onto the table or rug.

### 10 Connect the plug to an outlet.

- ◇ The [Start|Stop] key begins blinking. After approximately three seconds, it becomes possible to select a menu setting.
- ◇ If the lock bar is not turned to the lock position, menu selections will not be possible even when the plug is connected to an outlet.

### 11 Press the flavor selection keys and strength selection keys, or the [Dual Temp] key, to select your preferred flavor and strength, then press the [Start|Stop] key.

- ◇ The selected keys illuminate.
- ◇ When menu settings are being selected, the [Start|Stop] key blinks. When the [Start|Stop] key is pressed, coffee extraction starts, two beeps sound, and the [Start|Stop] key stops blinking and remains on.

#### ⚠ Caution

- Do not press and hold the [Dual Temp] key (for three seconds or longer). Doing so will change the operation sound setting. → P. 11

- ◇ A total of 10 patterns can be selected: three flavor stages × three strength stages (nine patterns) + one recommended pattern.

### Adjustment menu

#### ● Flavor selection keys

The flavor can be selected in three stages from [Acidic] to [Bitter].

#### ● Strength selection keys

The strength can be selected in three stages from [Light] to [Strong].

### Recommended menu setting

#### ● [Dual Temp] key

The Dual Temp Brewing Method begins by brewing at high temperature and then changes to low-temperature brewing midway through the process. This method of brewing reduces undesired flavors and allows you to enjoy the true flavor of the beans.

#### <Temperature of the coffee after extraction>

Because the brewing process changes to low temperature midway through, the temperature of the coffee after extraction may be lower than with other menu settings.

#### <Approximate extraction time>

Approximately 2.5 to 5 minutes

\* The extraction time varies depending on factors including the room temperature, amount of water, and amount of coffee grounds.

#### <If you pressed the wrong key>

You can take as much time as you like to make your selections before pressing the [Start|Stop] key.

#### <If no operations are performed for a certain time>

If no operations are performed for approximately one minute when the [Start|Stop] key has not been pressed, all LED turn off. Pressing any key will return them to the status from before they turned off.

#### <To cancel coffee extraction before it is completed>

Press the [Start|Stop] key. Coffee extraction cannot be resumed if it was canceled before it was completed. Throw out the coffee grounds, rinse the upper cylinder, lower cylinder, and filter, and drain the water from the path inside the main unit (→ P. 19). Then add new coffee grounds and water and begin the extraction process again from the beginning.

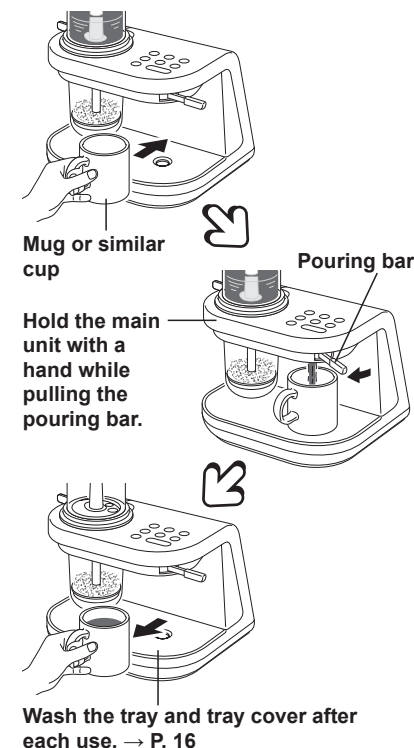

### 12 After coffee extraction is completed, place a mug or similar cup under the spout and pull the pouring bar to pour the coffee. After pouring the desired amount of coffee, release the pouring bar and remove the mug or similar cup.

#### ⚠ Caution

- Do not use a mug made of a material that is easily affected by heat. (It must be heat resistant to 120°C or higher.) There is the risk of deformation.
- Do not use a glass cup. (However heat-resistant glass can be used.)
- Do not remove the cylinder unit when there is coffee remaining in the upper cylinder. If there is remaining coffee, there is the risk of burns and/or spillage.

- ◇ When coffee extraction is completed, three long beeps sound, and the [Start|Stop] key turns off.
- ◇ After coffee extraction, wait for the coffee grounds to cool (around 10 minutes) before removing them and cleaning the filter. → P. 16
- ◇ After use, disconnect the plug from the outlet.

#### <For users who prefer hotter coffee>

- ◇ Use hot water or other means to heat up the cup before pouring the coffee.

#### <When you will continue and make more coffee>

- ◇ Wait for the hot parts to cool (around 10 minutes), then discard the used coffee grounds, rinse the upper cylinder, lower cylinder, and filter, and perform the extraction procedure again starting from P. 12.

#### <When two short beeps repeatedly sound every three seconds after coffee extraction>

- ◇ This is a notification that mineral component removal is necessary. Use citric acid and remove mineral components from the path inside the main unit. → P. 18
- Continuing to use the product without removing the mineral components may result in poor extraction, burns, or malfunction.

#### <When making iced coffee>

Add ice to the cup after pouring the coffee.





# How to Clean

- ◇ After use, wash out the path inside the main unit with hot water. → P. 18
- ◇ Disconnect the plug, and wait until this appliance has cooled down before cleaning.

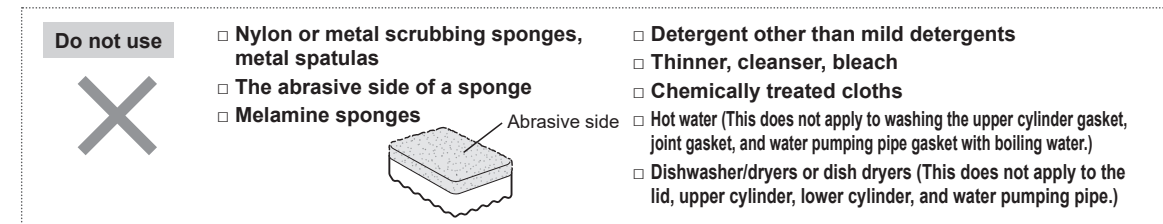
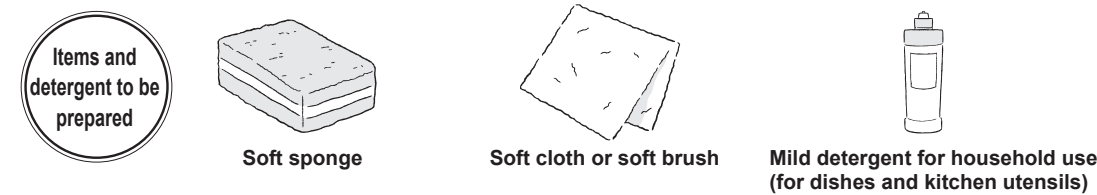

## Parts to wash after every use

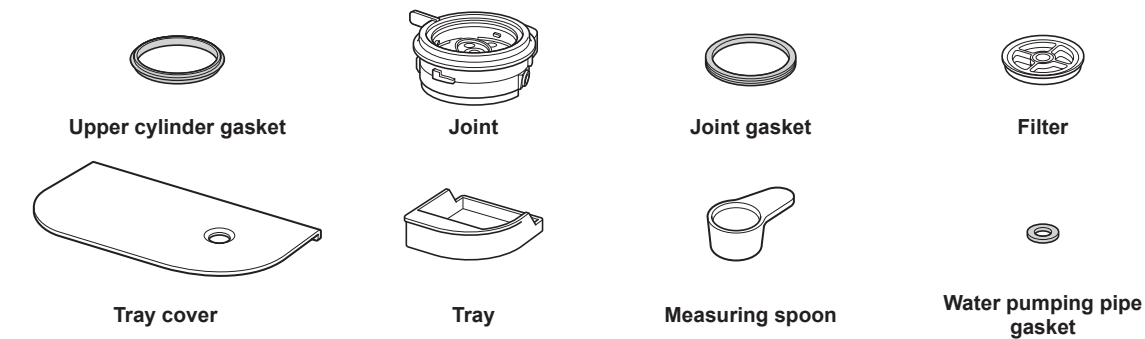

A dishwasher/dryer or dish dryer can be used for the following parts.

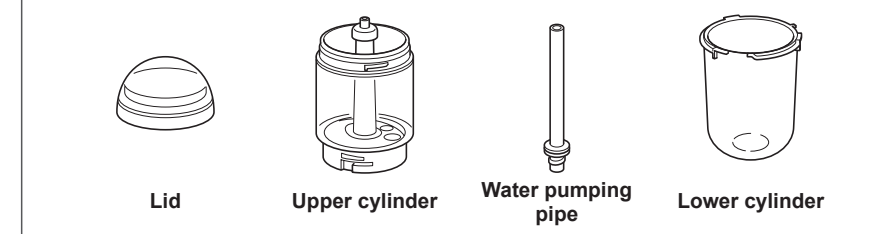

1. Wash the parts well using a sponge or the included pipe cleaning brush with detergent diluted with cold or lukewarm water, and rinse the parts with water.  
Removing parts → P. 10
2. Wipe the water off with a dry cloth and dry the parts thoroughly.

### Caution

- Do not use paint thinner, cleansers, bleach, chemically treated cloths, metal scrubbing sponges, or nylon scrubbing sponges.
- Do not use boiling water. (This does not apply to the upper cylinder gasket, joint gasket, and water pumping pipe gasket.)

## Using a dishwasher/dryer or dish dryer (lid, upper cylinder, lower cylinder, and water pumping pipe only)

Thoroughly read the instruction manual of the dishwasher/dryer or dish dryer before use.

### Caution

- Be sure to use detergent designed for the dishwasher/dryer.
- Do not use detergent containing citrus fruit extract. Doing so may cause parts to turn white.
- Avoid areas close to heaters and high-temperature parts. On models where the temperature can be set, select low temperatures.
- Parts may turn white if exposed to high temperatures.

## Places to clean as necessary

1. Soak a cloth in detergent diluted with cold or lukewarm water, firmly wring out the cloth, and then wipe off the parts. (Wipe the power cord and plug using a dry cloth.)
2. Wipe the detergent off with a dry cloth and dry the parts thoroughly.

### Caution

- Do not immerse the appliance in water or pour water on it.

Cylinder stand

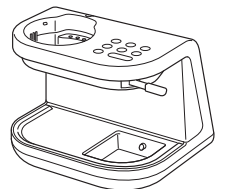

Main unit

When an odor remains on the parts (upper cylinder gasket, joint gasket, water pumping pipe gasket)

Odors on the upper cylinder gasket, joint gasket, or water pumping pipe gasket can be reduced by leaving the gasket in boiling water for approximately 30 minutes.  
If the odor is still a concern, please contact Tiger directly.

# How to Attach the Gaskets

- ◇ The upper cylinder gasket, joint gasket, and water pumping pipe gasket can be removed for cleaning.

## Attaching and removing the upper cylinder gasket

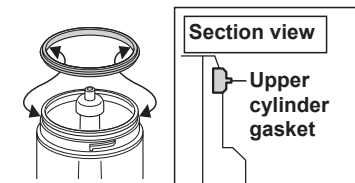

## Attaching and removing the joint gasket

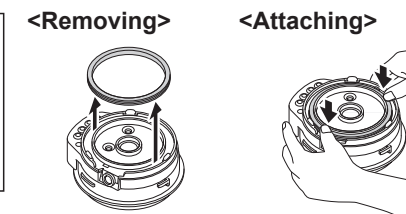

## Attaching and removing the water pumping pipe gasket



### Caution

- Attach gaskets correctly. Incorrectly attaching the joint gasket to the upper cylinder will prevent the lid from closing.
- Do not remove the large bottom gasket, small bottom gasket, small gaskets (in eight locations), and filter gasket. They cannot be reattached once removed.
- In the case of the large bottom gasket, small bottom gasket, small gaskets (in eight locations), or filter gasket being removed, please contact Tiger directly.

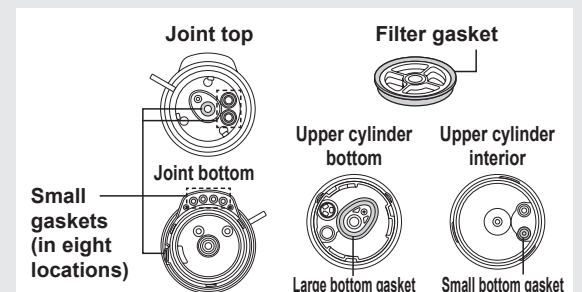

## How to Clean

### How to clean the path inside the main unit

Situation	Cleaning method
<ul style="list-style-type: none"> <li>When using the appliance for the first time or after a long time without use</li> <li>After extracting coffee</li> </ul>	<b>01</b> Rinsing the path inside the main unit with hot water
<ul style="list-style-type: none"> <li>When hot water does not flow through to the lower cylinder</li> <li>When hot water smells</li> <li>When using mineral water or alkali ion water</li> <li>When two short beeps repeatedly sound every three seconds after coffee extraction</li> </ul>	<b>02</b> Removing mineral components from the path inside the main unit
<ul style="list-style-type: none"> <li>When the appliance will not be used for a long time</li> <li>When operation stops or you stop operation during extraction</li> </ul>	<b>03</b> Draining water from the path inside the main unit

#### 01 Rinsing the path inside the main unit with hot water

◇ Flush hot water through the path inside the main unit to clean.

- Remove the upper cylinder (→ P. 10) and add water to its two cup scale line.
- Install the cylinder unit in the main unit without adding coffee grounds, select the [Dual Temp] key, and press the [Start|Stop] key.→ P. 12 to 15
- After extraction is complete, set a mug or a similar cup under the spout and pull the pouring bar to pour the hot water. Then, discard this water from the cup.  
◇ Continue pouring this hot water until there is none left in the upper cylinder.
- Repeat steps 1 to 3 once or twice.

#### 02 Removing mineral components from the path inside the main unit (cleaning with citric acid)

- ◇ After using citric acid water to remove mineral components from the path inside the main unit, rinse out this path.
- ◇ It is recommended that this cleaning be performed approximately once per month.

Scan the code for information on cleaning with citric acid.

#### ⚠ Caution

- Once cleaning with citric acid is started, no other operations will be possible until the rinsing process is complete.

- Remove the upper cylinder. (→ P. 10)
- Insert 10 g (1 tbsp) of citric acid in the upper cylinder, add water to its two cup scale line, mix until the citric acid dissolves, and then attach the lid.
- Install the tray and tray cover. → P. 13
- Connect the plug to an outlet.
- Install the cylinder unit onto the main unit, locking the cylinder unit in place. → P. 14 (Do not install the filter or water pumping pipe in the lower cylinder and do not put coffee grounds in it.)

#### <Process for cleaning with citric acid> Recommended time: 12 min 30 sec

- Press and hold the two keys indicated in square (1) at the same time for at least two seconds, and then press the [Start|Stop] key to start cleaning with citric acid.  
◇ Once cleaning with citric acid is started, no other menus can be used until the rinsing process is complete.

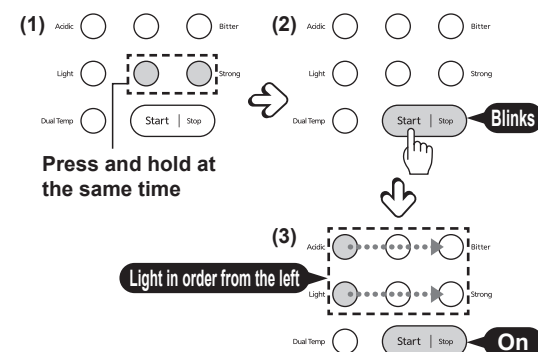

#### 02 Removing mineral components from the path inside the main unit (cleaning with citric acid; continued)

- When the cleaning with citric acid is complete, all flavor and strength selection keys light, and the [Start|Stop] key turns off.  
◇ Two short beeps will sound every 3 seconds.

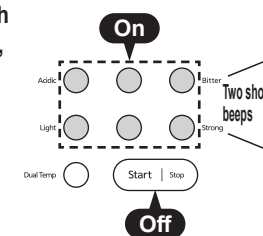

#### <Switching water>

- Remove the cylinder unit from the main unit (→ P. 10) and discard the citric acid water remaining in the lower and upper cylinders.
- Rinse the upper cylinder and add water to its two cup scale line.
- Install the cylinder unit onto the main unit, locking the cylinder unit in place. → P. 14 (Do not install the filter or water pumping pipe in the lower cylinder and do not put coffee grounds in it.)

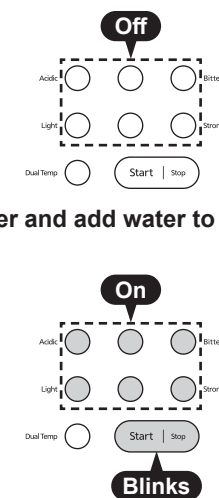

#### <Rinsing process>

Recommended time: 2 min 30 sec

- Press the [Start|Stop] key to start rinsing.

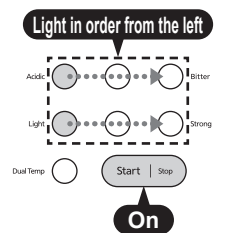

- When three long beeps sound, rinsing is complete.
- Discard the hot water that has collected in the lower cylinder.  
◇ If you are bothered by the smell of the citric acid water or if you forgot to put water in the upper cylinder in step 9, carry out the procedure under "01 Rinsing the path inside the main unit with hot water."

#### Cleaning with citric acid

Use commercially available food-grade citric acid. Carefully read the safety precautions when using citric acid.

#### 03 Draining water from the path inside the main unit

◇ Drain into the lower cylinder the water remaining in the path inside the main unit.

- Rinse the upper and lower cylinders and drain them.  
◇ Remaining coffee and water will flow into the path inside the main unit.
- Perform steps 3 to 6 under "02 Removing mineral components from the path inside the main unit" without inserting water or citric acid.  
◇ If you insert water, the process for cleaning with citric acid will automatically start. If you insert water by mistake, perform steps 7 to 11 under "02 Removing mineral components from the path inside the main unit." Once cleaning with citric acid is started, no other menus can be used until rinsing is complete.
- When three long beeps sound, draining is complete.
- Discard the water that has collected in the lower cylinder.

# Troubleshooting

Check the following before requesting repairs.

Symptom	Point to check	Action to take	Page to check
• Nothing happens when a key is pressed.	→ Is the plug connected to an outlet?	→ Connect the plug to an outlet.	→ 14
	→ Has the lock bar been turned to the correct position?	→ Turn the lock bar to the position where it is perfectly horizontal.	→ 14
• The lock bar does not turn.	→ Is the cylinder unit installed in the main unit correctly?	→ Correctly install the cylinder unit onto the main unit. The lock bar will not move if the cylinder unit is not installed in the main unit.	→ 14
• Hot water is not poured into the lower cylinder.	→ Is water in the upper cylinder?	→ Add water to the upper cylinder.	→ 13
	→ Is the upper cylinder installed correctly?	→ Install the upper cylinder correctly.	→ 10
• Coffee is not extracted into the upper cylinder.	→ Is the upper cylinder gasket installed correctly?	→ Install the upper cylinder gasket correctly.	→ 17
	→ Is the lid attached correctly?	→ Securely attach the lid.	→ 13
	→ Are you using superfine coffee grounds?	→ Use medium-fine or larger coffee grounds.	→ —
• Hot water or coffee overflows from the tray.	→ Has the tray been left with hot water or something similar inside it?	→ Use the appliance with nothing inside the tray.	→ —
	→ Is the mug or similar cup not under the spout?	→ Place the mug or similar cup under the spout.	→ 15
• Coffee overflows from the upper or lower cylinder.	→ Has too much water been added to the upper cylinder?	→ Do not add water to the upper cylinder past its two cup scale line.	→ 13
• Extraction stops before completion.	→ Has water been added to the upper cylinder?	→ Add water at least up to the one cup scale line on the upper cylinder.	→ 13
	→ The path inside the main unit may be clogged with mineral components.	→ Use citric acid to remove mineral components from the path inside the main unit.	→ 18
• The amount of coffee extracted is low.	→ Are you using superfine coffee grounds?	→ Use medium-fine or larger coffee grounds.	→ —
• Coffee is lukewarm.	→ The [DualTemp] key is designed to switch to low the temperature of the hot water to extract partway through the process to reduce undesired flavors. Using a warm mug or similar cup will help prevent the coffee from cooling.		→ 15
• After extraction, a substance similar to oil floats in the coffee poured into the cup.	→ This is not a malfunction. A small amount of oil is extracted from the coffee beans.		→ —
• The appliance is loud or vibrates heavily during operation.	→ This is the sound or vibration of the pump in the main unit raising the water. It is not a malfunction.		→ —
• There are what appear to be scratches (chips) on the resin parts.	→ These traces occurred during molding and do not affect the proper functioning of the product.		→ —
• There is a smell of resin.	→ Although resin or other materials may smell for the first several uses, such odors become less noticeable with use.		→ —

## Error displays and actions to be taken

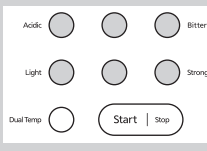
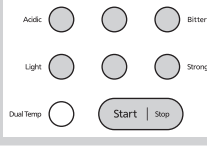
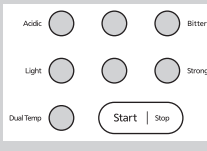
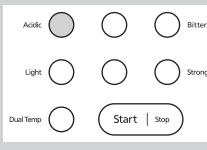
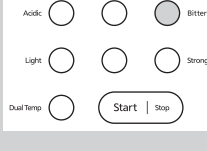
Buzzer sound and display	Cause	Action to take	Page to check
<ul style="list-style-type: none"> <li>• All flavor and strength selection keys light, and two short beeps repeatedly sound at an interval of 3 seconds.</li> </ul> 	→ This is not an error. Mineral removal is in progress. This is a notification that the water in the upper cylinder must be discarded.	→ Release the lock provided by the lock bar to stop the sound. Discard the water in the upper cylinder, add new water, and then carry out the rinsing process.	→ 19
<ul style="list-style-type: none"> <li>• All flavor and strength selection keys light, and the [Start/Stop] key blinks.</li> </ul> 	→ This is not an error. Mineral removal is in progress. This is a notification that the rinsing process must be started.	→ Add water to the upper cylinder, press the [Start/Stop] key, and then wait for the rinsing process to finish.	→ 19
<ul style="list-style-type: none"> <li>• Two short beeps repeatedly sound at an interval of 3 seconds after extraction.</li> </ul>	→ This is not an error. This is a notification that scheduled mineral component removal is necessary.	→ Use citric acid to remove mineral components from the path inside the main unit.	→ 18
<ul style="list-style-type: none"> <li>• All keys light at the same time, and a continuous beep sounds.</li> </ul> 	→ The heater has overheated. The path inside the main unit may be clogged with mineral components.	→ Use citric acid to remove mineral components from the path inside the main unit. → P. 18 → If the problem persists even after multiple cleaning operations, contact TIGER CORPORATION U.S.A. to request repair.	→ —
<ul style="list-style-type: none"> <li>• The flavor selection keys blink continuously and 16 short beeps sound.</li> </ul> 	→ The temperature sensor has malfunctioned.	→ Contact TIGER CORPORATION U.S.A. to request repair.	→ —
	→ Extraction takes too long. The path inside the main unit may be clogged with mineral components. There may be an error in the path inside the main unit.	→ Use citric acid to remove mineral components from the path inside the main unit. → P. 18 → If the problem persists even after multiple cleaning operations, contact TIGER CORPORATION U.S.A. to request repair.	→ —
<ul style="list-style-type: none"> <li>• With the selected key lit, pressing the [Start/Stop] key does not start the operation. Instead, three short beeps sound.</li> </ul>	→ You cannot press the [Start/Stop] key to start the next operation immediately after extraction finishes.	→ Wait approximately 10 minutes, add new coffee grounds and water, install the cylinder unit, and then press the [Start/Stop] key.	→ 12 to 15
<ul style="list-style-type: none"> <li>• Three short beeps sound, all keys turn off, and operation stops.</li> </ul>	→ Operation stops if the lock provided by the lock bar is released during extraction.	→ Do not touch the lock bar during extraction.	→ —
<ul style="list-style-type: none"> <li>• Three short beeps sound, the [Start/Stop] key turns off, and operation stops.</li> </ul>	→ No water is flowing into the path inside the main unit.	→ Add water to the upper cylinder and install it correctly.	→ 13
	→ The path inside the main unit may be clogged with mineral components.	→ Use citric acid to remove mineral components from the path inside the main unit. → P. 18 → If the problem persists even after multiple cleaning operations, contact TIGER CORPORATION U.S.A. to request repair.	→ —

# Specifications

Power source	Power consumption (W)	Water capacity* (L)	Outside dimensions* (cm)			Weight* (kg)	Cord length* (m)
			Width	Depth	Height		
120VAC, 60 Hz	1285	0.29	31.3	23.9	36.6	5.0	1.4

\* Indicates an approximate value.

# Purchase of consumables and options

- ◇ Gaskets are consumable parts. If they smell bad or are heavily dirty or damaged, please contact Tiger directly.
- ◇ Parts that come into contact with heat or steam may become worn out in use. Please contact Tiger directly.