

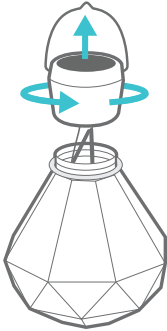

Solar Gem Light

Congratulations on the purchase of the Solar Gem Light by Allsop Home & Garden! Setting up your Solar Gem Light is simple, follow the steps below:



1. Carefully Take Off Top Compartment

Twist Solar housing compartment counter-clockwise and lift off from glass vessel. Be very careful when lifting out LED filament.

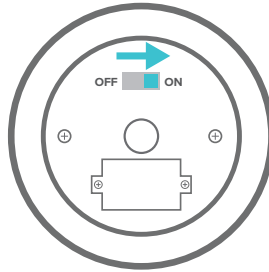

2. Slide Switch to On

On the underside of the solar housing compartment, slide the On/Off switch from the "off" position into the "on" position.

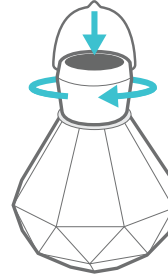

3. Put Top Compartment Back On

Twist solar housing compartment back onto the glass Gem Light vessel by rotating clockwise until it locks into the glass vessel and is secure.

Further instructions on back →

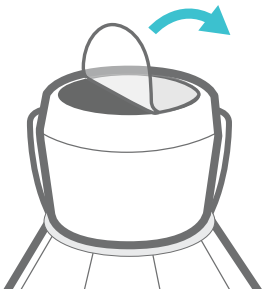

4. Remove Protective Sheet
Gently remove clear protective sheet from solar panel.

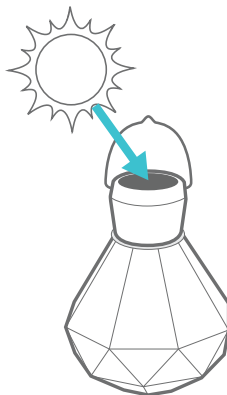

5. Place/Hang Lantern Outside in Sunlight
Place Solar Gem Light on a table top or flat surface or hang as a solar pendant light. For optimum glow time be sure to place the solar Gem Light in a location where it will receive direct sunlight for 6 to 8 hrs. Designed for outdoor use.



6. Enjoy!

ALLSOP
HOME  GARDEN