

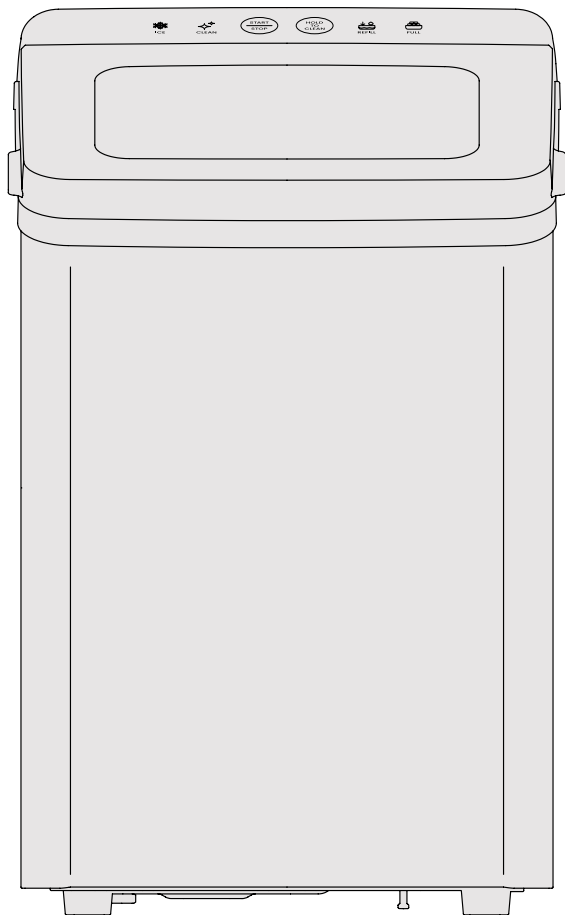

The Pebble

Countertop

Ice Machine



RJ56-PB18-SS

Get to Know Your Ice Maker

1. Front cover with viewing window
2. Control panel
3. Ice tray (inside)
4. 1.8L water reservoir with MAX fill line
5. Air vent
6. Ice basket
7. Ice scoop
8. Water drain plug (on bottom, not shown)

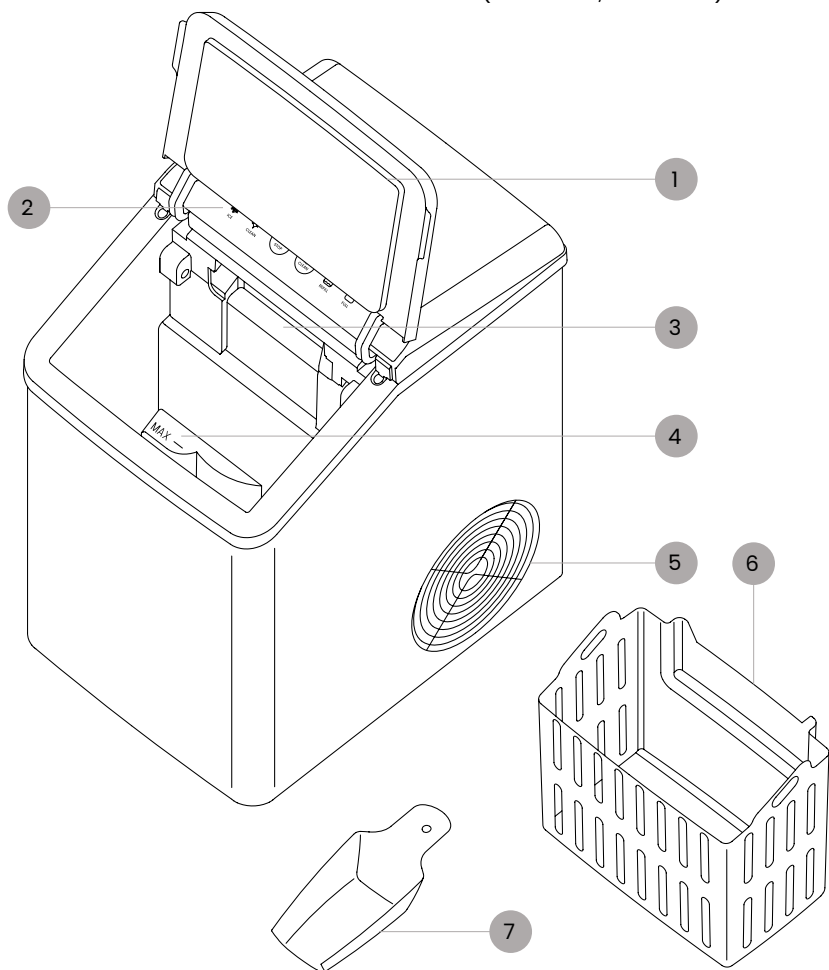

Control Panel

1. ICE indicator light
2. CLEAN indicator light
3. START-STOP button
4. HOLD TO CLEAN button
5. REFILL indicator light
6. FULL indicator light

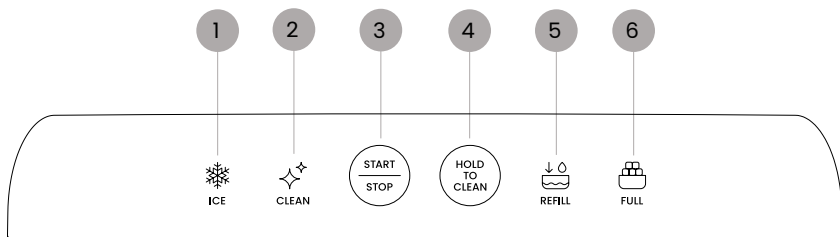

READ ALL INSTRUCTIONS BEFORE USE

For your safety and continued enjoyment of this product, always read the instruction manual before using.

Safety Instructions & Important Safeguards

1. Read all instructions.
2. **DANGER!** To protect against the risk of electric shock, do NOT immerse the cord, plug, or any part of the unit in water or other liquid.
3. Close supervision is necessary when using this appliance near children. This appliance is not suitable for use by children.
4. Never leave an appliance unattended while in use.
5. **Do NOT** place an appliance on or near a hot gas or electric burner, or in a heated oven. **Do NOT** place on top of any other appliance.
6. **Do NOT** let the power cord of the appliance hang over the edge of a table or countertop or touch any hot surface.
7. **Do NOT** operate any electrical appliance with a damaged cord or plug or after the appliance malfunctions or has been dropped or damaged in any manner. If damage is suspected, contact Chefman® Customer Support for examination, repair, or electrical or mechanical adjustment.
8. Unplug the appliance from the power outlet when not in use, before putting on or taking off attachments, and before cleaning.
9. The use of accessory attachments that are not recommended by the manufacturer may cause fire, electric shock, or injury.
10. Avoid contact with moving parts when the unit is in operation.
11. Never touch the cooling elements when the unit is in operation.
12. **Do NOT** use outdoors.
13. **Do NOT** use an appliance for anything other than its intended use.

**Save these instructions
For household use only**

Safety Instructions & Important Safeguards

WARNING: Improper use of the grounding plug can result in electric shock.

Grounding Instructions

This appliance must be grounded. In the event of an electrical short circuit, grounding reduces the risk of electric shock by providing an escape wire for the electric current. To protect against electrical shock, this appliance is equipped with a cord having a 3-prong grounding-type plug for insertion into a proper grounding-type electrical outlet. **Do NOT** alter the plug for use in a 2-prong outlet. If the plug will not fit into an outlet, have a proper outlet installed by a qualified electrician.

Do NOT alter the plug for use in a 2-prong outlet. If the plug will not fit into an outlet, have a proper outlet installed by a qualified electrician.

Safety Instructions & Important Safeguards

Short Cord Instructions

A short power-supply cord is provided to reduce the hazards of entanglement or tripping over a longer cord. Longer detachable power-supply cords or extension cords are available and may be used if care is exercised in their use. If a longer detachable power-supply extension cord is used:

1. The marked electrical rating of the extension cord should be at least as great as the electrical rating of the appliance.
2. If the appliance is of the grounded type, the extension cord should be a grounding-type 3-wire cord; and
3. The longer cord should be arranged so that it will not drape over the countertop or tabletop where it can be pulled on by children or tripped over.

Power Cord Safety Tips

1. Never pull or yank on the cord or the appliance.
2. To insert the plug, grasp it firmly and guide it into the outlet.
3. To disconnect the appliance, grasp the plug and remove it from the outlet.
4. Never use the product if the power cord shows signs of abrasion or excessive wear. Contact Chefman® Customer Support for additional guidance and support.
5. Never wrap the cord tightly around the appliance, as this could place undue stress on the cord where it enters the appliance and cause it to fray and break.

DO NOT OPERATE THE APPLIANCE IF THE POWER CORD SHOWS ANY DAMAGE OR IF THE APPLIANCE WORKS INTERMITTENTLY OR STOPS WORKING ENTIRELY.



California Proposition 65:

(Applicable for California Residents only)

WARNING: Cancer and Reproductive Harm
www.P65Warnings.ca.gov

Do not place the appliance on a stovetop or any other heatable surface, even if stovetop is not on. Doing so is a fire hazard.



How to Use the Ice Maker

Before First Use:

1. Remove all packaging materials, such as plastic bags and foam inserts. Check to ensure that all parts and accessories are included before throwing out packaging.
2. Read and remove any stickers on the ice maker except for the rating label, which should remain on the unit.
3. Wipe down the interior and exterior with a damp cloth or paper towel and dry thoroughly. Wash the removable ice basket and ice scoop with a sponge and warm, soapy water, and dry completely.
4. Place the ice maker on a level surface away from direct sunlight and other heat sources. Keep at least 6 inches of clearance on all sides of the unit to ensure proper ventilation. **NOTE:** If using the unit outdoors, be cautious of weather and extreme temperatures (ideal ambient temperature is between about 50°F/10°C and 90°F/32°C), as these can affect the ice-making process or damage the unit.
5. **IMPORTANT:** Wait 2 hours for the refrigerant fluid to settle before plugging the unit in for the first time.
6. Before making ice for the first time, prime the ice maker by running the self-cleaning function (see Keep It Clean on p. 12).

Quick Start: How to Make Ice

The ice maker completes a batch of easy-to-make, restaurant-style ice in less than 20 minutes, perfect for all of your ice needs.

1. Make sure the drain plug on the bottom of the unit is closed. If it is not, push it firmly into place.

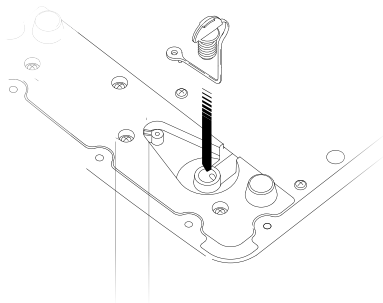

2. Set the ice maker on a hard, level surface away from any sources of heat, with at least 6 inches of clearance on all sides for proper ventilation. Plug in the ice maker. **NOTE:** If the ice maker has been moved since its last use, let it sit for 30 minutes before plugging it in, to allow the refrigerant fluid to settle.

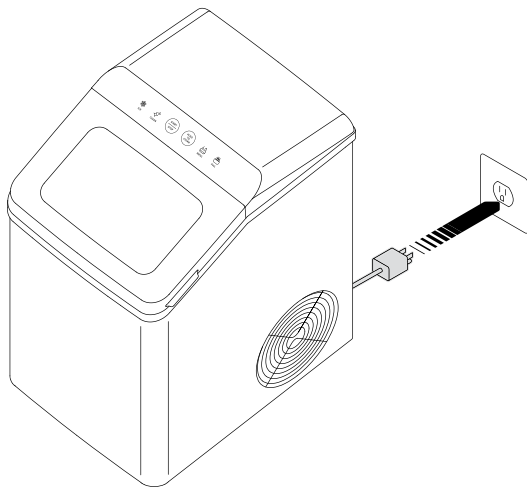

3. Open the front cover and lift out the ice basket.
4. Fill the water reservoir with filtered or bottled water up to but not exceeding the **MAX** fill line. To ensure sanitation, be sure to change the water in the reservoir once a day. **CAUTION:** Only use cold to room temperature water, as hot water can damage the unit.

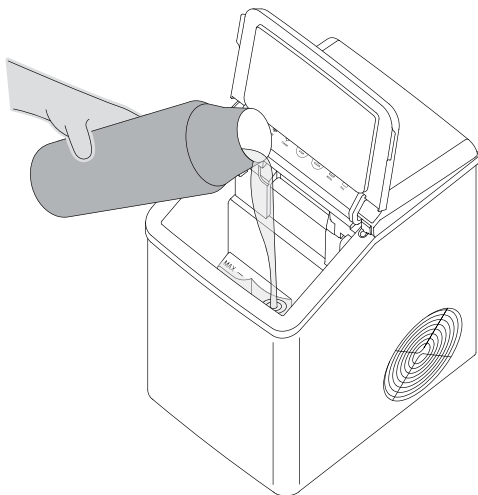
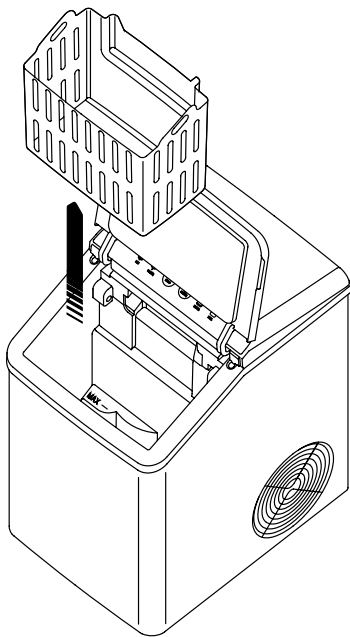

5. Replace the ice basket and close the front cover.

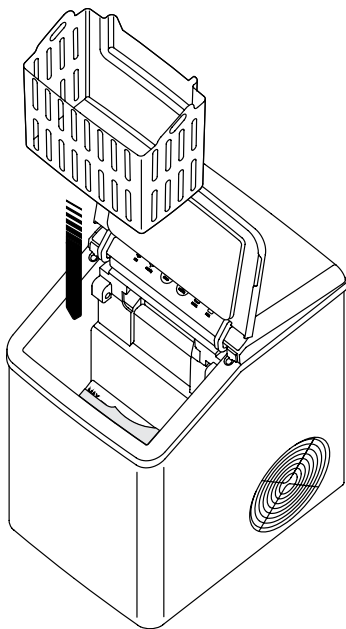

6. Press the **START-STOP** button. The **ICE** indicator light will illuminate and ice-making will begin. The ice maker will run continuously until it is turned off or the ice basket is full. It will begin producing ice in about 20 minutes and should produce a full basket in as little as 1 hour and 40 minutes (when filled to the MAX line), depending on ambient temperature and water temperature.

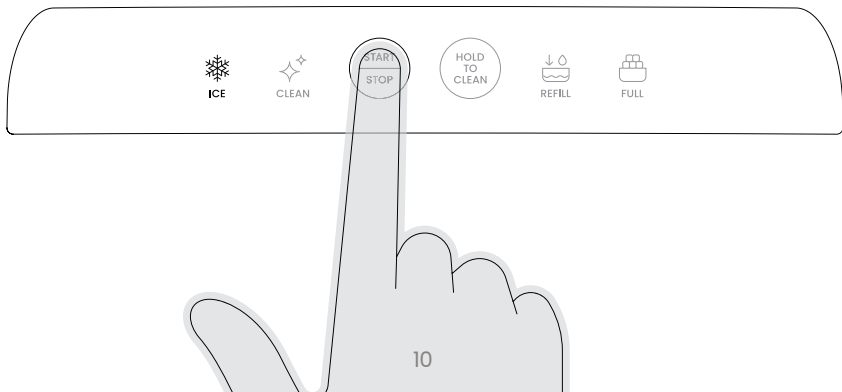

7. Use the ice scoop to remove and serve ice. The ice maker will not keep ice cold for extended periods of time. Store extra ice in the freezer for later use, if desired, or allow the unused ice to melt. Melted ice will drip back into the water reservoir and be reused during the ice-making process.

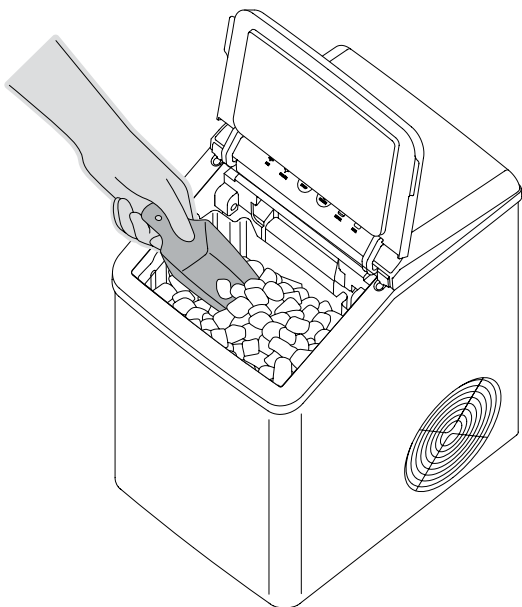

8. When the ice basket is completely full, the **FULL** indicator light will illuminate and ice-making will stop. Once enough ice is removed, the ice-making cycle will restart automatically. **NOTE:** You do not need to wait for the ice basket to be completely full before removing ice. Ice can be used at any time throughout the cycle.
9. If there is not enough water to complete an ice-making cycle, the **REFILL** indicator light will come on and ice-making will stop. Refill the reservoir, close the front cover, and ice-making will resume automatically.
10. If using the ice maker daily, conserve energy by unplugging it or powering it off overnight and when not needed for immediate use.

Keep It Clean

To keep your ice tasting fresh and your ice maker in prime condition, we recommend changing the water in the reservoir once a day and cleaning your ice maker at least once per week.







1. Make sure the ice maker is unplugged and at room temperature.
2. Place the unit over a proper drainage area and remove the ice basket. Pull out the drain plug on the bottom of the unit to empty the water from the reservoir. Wipe down the interior with a cloth or paper towel soaked in a mixture of water and vinegar. Rinse thoroughly and dry completely. Replace the drain plug, pushing it firmly into place.
3. Wipe down the exterior with a damp cloth or paper towel, using a mild dishwashing soap, if necessary. **Do NOT** put the unit in the dishwasher or submerge it in water or any other liquid. **Do NOT** use abrasive cleansers, or you could damage the finishes.
4. Wash the removable ice basket and scoop with a sponge and warm, soapy water, and dry completely. The basket and scoop are not dishwasher safe.
5. To clean the ice maker's internal parts, follow the instructions below to activate the self-cleaning feature when needed.
6. Always empty the water reservoir and dry completely for storage or if the ice maker will not be used for an extended period of time. This will prevent mold and mildew from forming.

Self-Cleaning Feature

The ice maker is equipped with a self-cleaning feature to ensure easy and complete sanitation. This feature should be used at least once per week.

1. If necessary, remove any ice and empty the water reservoir by pulling out the drain plug. Replace the drain plug, pushing it in firmly to ensure it is closed properly.
2. Fill the water reservoir to the **MAX** line with clean water.
3. Press the **HOLD TO CLEAN** button for about three seconds until the **CLEAN** indicator light illuminates. The cleaning function will begin automatically and runs for approximately 5 minutes.
4. When the cleaning cycle is complete, empty the water reservoir by pulling out the drain plug. Follow the instructions to begin making ice, or dry completely for storage.

Having Trouble?

Problem	Likely Cause	Solution
 on when water reservoir is full.	The water screen at the bottom of the reservoir is blocked. Alternatively, the internal parts are blocked and/or need to be descaled.	Check to ensure no objects are obstructing the water reservoir. Follow the instructions for the self-cleaning feature on p. 12, adding a small amount of white vinegar for descaling, if necessary.
 on when ice basket is not full.	The small infrared sensors located on the sides of the ice tray are not working properly.	Unplug the ice maker. Wipe away any foreign substances that may be blocking or covering the sensors, then restart the ice maker. If the sensors appear to be damaged, contact Chefman® Customer Support for assistance.
 on and  blinking OR  and  blinking.	The ice maker's parts are frozen or defrosting.	Unplug the ice maker and wait 30 minutes to 1 hour for the unit to defrost. Run the self-cleaning feature described on pg. 12 before restarting the ice-making cycle. If this issue continues to occur, contact Chefman® Customer Support for assistance.
The ice maker is not working, or the ice-making cycle is activated but no ice is being produced.	There is not enough clearance around the ice maker; the ambient temperature is too high; and/or the water is too hot.	Make sure there is at least 6 inches of clearance on all sides of the ice maker. Move the ice maker to a cooler environment (between approximately 50°F/10°C and 90°F/32°C) and fill the reservoir with cold water.
The water pump is making noise and/or not pumping water.	The water pump (located inside the unit) is clogged, preventing water from pumping through smoothly and/or causing air to get trapped in the pump.	Clean the unit at least once per week to avoid buildup and to ensure that the parts continue to function properly. Use the self-cleaning feature described on p. 12 to unclog the pump, adding a small amount of mild dish soap or white vinegar, if necessary.
Water is leaking from the unit.	The drain plug is not closed properly or there is an issue with the internal parts.	Make sure the drain plug is pushed in fully. Otherwise, contact Chefman® Customer Support for assistance.
The ice produced is misshapen or broken.	If the ice maker continues to produce broken ice for more than 2 hours, there is poor heat distribution. Alternatively, the ambient or water temperature is too high.	For proper ventilation, ensure there is at least 6 inches of empty space on all sides of the unit. Move the ice maker to a cooler area and refill the water reservoir with cold water.

Having Trouble?

Problem	Likely Cause	Solution
The ice is clumping together.	The unit is taking too long to make ice and/or the water temperature is too low.	Stop the ice-making cycle and remove any accumulated ice. Empty the water reservoir and refill with cool or room temperature water. Restart the unit and begin a new ice-making cycle.
The ice has a strange taste.	The water is not fresh or the ice maker needs to be cleaned.	Refill the reservoir with clean water regularly (at least once per day). Otherwise, use the self-cleaning feature described on p. 12 to sanitize the unit's internal parts.

[illegible]

Terms and Conditions

Limited Warranty

RJ Brands, LLC d/b/a Chefman® offers a limited 1-year Warranty (the “Warranty”) available on sales through authorized distributors and retailers only. Please note that this Warranty becomes valid from the date of initial retail purchase and that the Warranty is non-transferable and applies only to the original purchaser.

This Warranty is void without proof of purchase within the United States and Canada. Please be aware that this Warranty supersedes all other warranties and constitutes the entire agreement between the consumer and Chefman®. Any changes to the Terms and Conditions of this Warranty must be in writing, signed by a representative of Chefman®. No other party has the right or ability to alter or change the Terms and Conditions of this Warranty.

We may ask you to please submit, via email, photos and/or video of the issue you are experiencing. This is to help us better assess the matter and possibly offer a quick fix. Photos and/or video may also be required to determine Warranty eligibility.

We encourage you to register your product. Registering can make the Warranty process easier and can keep you informed of any updates or recalls on your product. To register, follow the directions on the Chefman® Warranty Registration page in the Chefman® User Guide. Please retain your proof of purchase even after registering. In the event that you do not have proof of your purchase date, we may declare your Warranty void or we may, at our sole discretion, apply the date of manufacture as the purchase date for purposes of this Warranty.

What the Warranty Covers

- **Manufacturer Defects** – Chefman® products are warranted against defects in material and workmanship, under normal household use, for a period of 1 year from the date of purchase when used in accordance with the directions listed in the Chefman® User Guide. If your product does not work as it should, please contact Customer Support at support@chefman.com so that we may assist you.

This Warranty Does Not Cover

- **Misuse**
Damage that occurs from neglectful or improper use of products, including, but not limited to, damage that occurs as a result of usage with incompatible voltage, regardless of whether the product was used with a converter or adapter. See Safety Instructions in the Chefman® User Guide for information on proper use of product;
- **Poor Maintenance**
General lack of proper care. We encourage you to take care of your Chefman® products so that you may continue to enjoy them. Please see Cleaning and Maintenance directions in the Chefman® User Guide for information on proper maintenance;
- **Commercial Use**
Damage that occurs from commercial use;
- **Normal Wear and Tear**
Damage or degradation expected to occur due to normal use over time;
- **Altered Products**
Damage that occurs from alterations or modifications by any entity other than Chefman® such as the removal of the rating label affixed to the product;
- **Catastrophic Events**
Damage that occurs from fire, floods, or natural disasters; or
- **Loss of Interest**
Claims of loss of interest or enjoyment.

For product information, please visit us at Chefman.com/Iceman.

EXCEPT WHERE SUCH LIABILITY IS REQUIRED BY LAW, THIS WARRANTY DOES NOT COVER, AND CHEFMAN® SHALL NOT BE LIABLE FOR, INCIDENTAL, INDIRECT, SPECIAL, OR CONSEQUENTIAL DAMAGES, INCLUDING WITHOUT LIMITATION, DAMAGE TO, OR LOSS OF USE OF THE PRODUCT, OR LOST SALES OR PROFITS OR DELAY OR FAILURE TO PERFORM THIS WARRANTY OBLIGATION. THE REMEDIES PROVIDED HEREIN ARE THE EXCLUSIVE REMEDIES UNDER THIS WARRANTY, WHETHER BASED ON CONTRACT, TORT OR OTHERWISE.

Warranty Registration

What do I need to register my product?

- Contact Information
- Model Number
- Proof of Purchase (online confirmation, receipt, gift receipt)
- Date Code
- Access Code

CHEFMAN

Model/Modele: RJ25-C

Conveyor toaster

120v~60hz 1800W

CONFORMS TO UL STD. 1026

CERTIFIED TO CSA STD.C22.2 No.64

CAUTION: DO NOT IMMERSE IN WATER

ATTENTION: NE PAS PLONGER DANS L'EAU

WARNING: TO PREVENT ELECTRIC SHOCK,

UNPLUG BEFORE CLEANING

PRÉAVIS: POUR ÉVITER LES CHOCs ÉLECTRIQUES,

DÉBRANCHEZ L'APPAREIL AVANT DE L'UTILISER

READ INSTRUCTIONS BEFORE USING

LISEZ LES INSTRUCTIONS AVANT DE L'UTILISER

HOUSEHOLD USE ONLY

POUR USAGE DOMESTIQUE SEULEMENT

Date Code:

0000

Access Code:

Xxxxxxxx

Made in China/Fabrique en Chine
AC Only/ AC Seulement

NOTE: Label depicted here is an example.

How do I register my product?

All you need to do is fill out a simple Chefman® registration form. You can easily access the form in one of the two ways listed below:

- Visit Chefman.com/register.
- Scan the QR code to the right to access site.





The Pebble

Countertop Ice Machine

RJ56PB18SSUG12623

Chefman® is a registered trademark of RJ Brands, LLC.

Iceman™ is a trademark of RJ Brands, LLC.

Iceman™ designed by ©Chefman 2023.