

BYRNE

INSTALLATION INSTRUCTIONS FOR CUSTOM NEMCHOFF AXIL® Z

Install data jacks as described in the installation instructions provided with data adapters, BE03655

Windows	"X" Dim.
2 Windows	3-3/4"
3 Windows	5-1/4"
4 Windows	6-3/4"
5 Windows	8-1/4"
6 Windows	9-3/4"
7 Windows	11-1/4"
8 Windows	12-3/4"

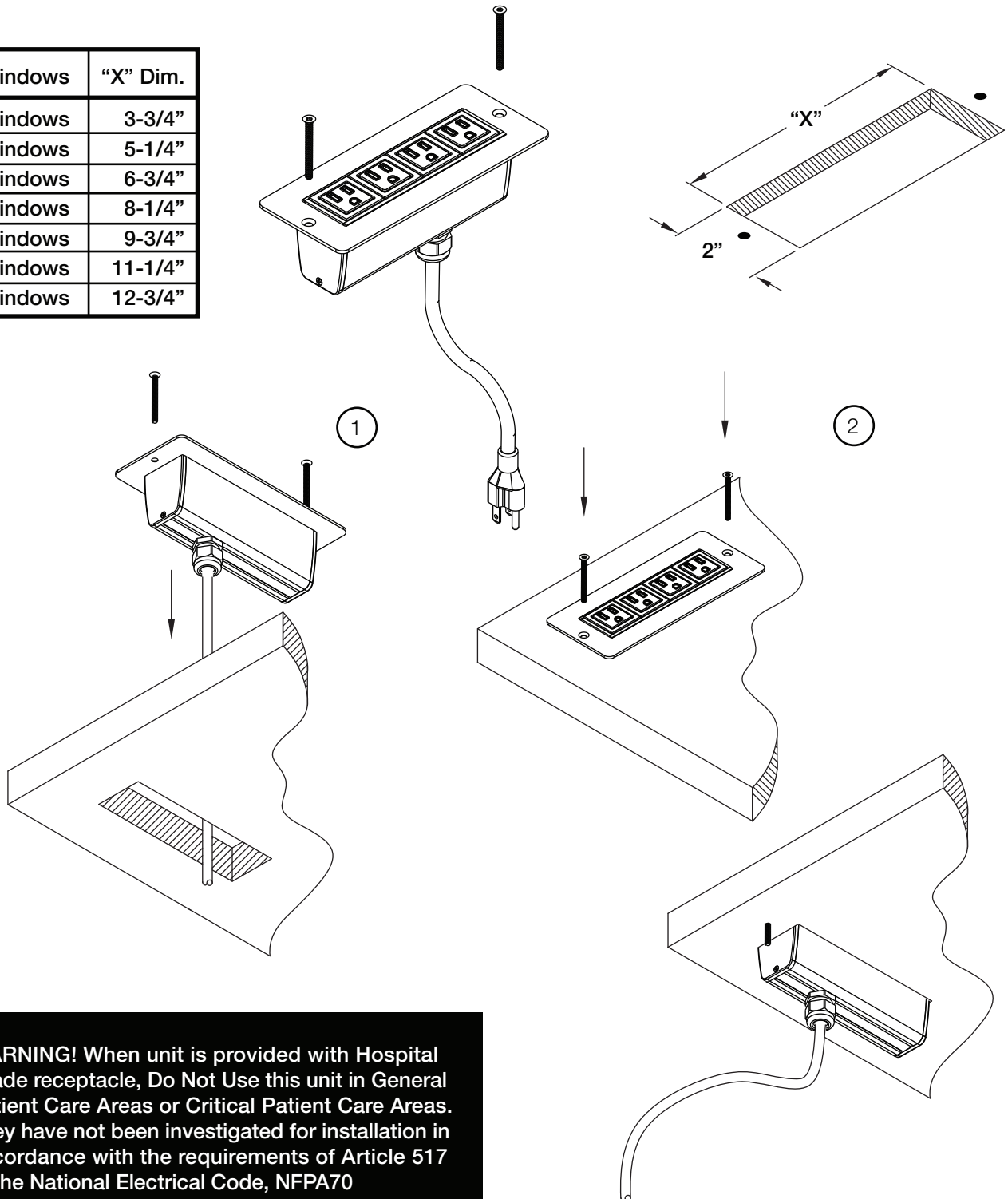

WARNING! When unit is provided with Hospital Grade receptacle, Do Not Use this unit in General Patient Care Areas or Critical Patient Care Areas. They have not been investigated for installation in accordance with the requirements of Article 517 of the National Electrical Code, NFPA70