

brim[®]
since 1961

Electric Handheld Burr Grinder { Instruction Manual

Table of Contents

Important Safeguards	2-3
Additional Important Safeguards	4
Notes on the Cord.....	5
Electric Power.....	5
Getting to Know Your brim Handheld Burr Grinder.....	6
Grinding Coffee Beans	8-9
Before Using for the First Time	7
Perfect the Art of Coffee Grinding.....	7
Coffee Bean Grinding Chart	10
Hints for Best Results	10
Not Recommended.....	10
User Maintenance Instructions	11
Care & Cleaning Instructions.....	11
Storing Instructions	11
Warranty	12-13
Tasting Notes.....	14-20

IMPORTANT SAFEGUARDS

When using electrical appliances, basic safety precautions should always be followed, including the following:

1. **READ ALL INSTRUCTIONS.**
2. To protect against risk of electrical shock do not put cord, plugs, or the Electric Handheld Burr Grinder in water or other liquid.
3. This appliance is not intended for use by persons (including children) with reduced physical, sensory or mental capabilities, or lack of experience and knowledge, unless they have been given supervision or instruction concerning use of the appliance by a person responsible for their safety.
4. Close supervision is necessary when any appliance is used by or near children.
5. Unplug from outlet when not in use, before putting on or taking off parts, and before cleaning.
6. Do not operate any appliance with a damaged cord or plug or after the appliance malfunctions, or is dropped or damaged in any manner. Contact Consumer Service for examination, repair or mechanical or electrical adjustment.
7. The use of attachments not recommended or sold by the manufacturer may cause fire, electric shock or injury.
8. Avoid contacting moving parts.

8. Do not use outdoors.
9. Do not let cord hang over edge of table or counter.
10. Do not let cord contact hot surfaces, including stove.
11. Check the coffee bean hopper for presence of foreign objects before using.

CAUTION: Do not immerse the Electric Handheld Burr Grinder housing in water!

FOR HOUSEHOLD USE ONLY

SAVE THESE INSTRUCTIONS

ADDITIONAL IMPORTANT SAFEGUARDS

All users of this appliance must read and understand this instruction manual before operating or cleaning this appliance.

1. The cord to this appliance should be plugged into a 120V AC electrical outlet only.
2. Do not leave this appliance unattended during use.
3. If this appliance begins to malfunction during use, immediately press the ON/OFF button to turn the unit OFF and unplug the cord. Do not use or attempt to repair the malfunctioning appliance.
4. If this appliance falls or accidentally becomes immersed in water, unplug it immediately. Do not reach into the water! Do not use this appliance after it has fallen into or becomes immersed in water.
5. To reduce the risk of injury to persons or property, never use this appliance in an unstable position.
6. Do not use this appliance for other than its intended use.

Notes on the Cord

- a) A short power adapter cord is provided to reduce risks resulting from becoming entangled in or tripping over the cord.
- b) Longer power-supply cords or extension cords are available and may be used if care is exercised in their use.
- c) If a long power-supply cord or extension cord is used:
 - 1) The marked electrical rating of the power-supply cord or extension cord should be at least as great as the electrical rating of the appliance;
 - 2) If the appliance is of the grounded type, the extension cord should be a grounding- type 3-wire cord; and
 - 3) The longer cord should be arranged so that it will not drape over the counter top or table top where it can be pulled on by children or tripped over.

Electric Power

If the electrical circuit is overloaded with other appliances, your Electric Handheld Burr Grinder may not operate properly. It should be operated on a separate electrical circuit from other appliances.

Getting to Know Your brim Handheld Burr Grinder

Product may vary slightly from illustration

1. Silicone Comfort Grip
2. ON/OFF Button
3. Power Port (not shown)
4. Power Adapter with Polarized Plug
5. Grinding Hopper LOCK/UNLOCK Icons
6. Grinding Blade
7. Coffee Bean Hopper
8. Grind Tray
9. Grinding Dial
10. Tray Door
11. Bottom Ring
12. Measuring Scoop

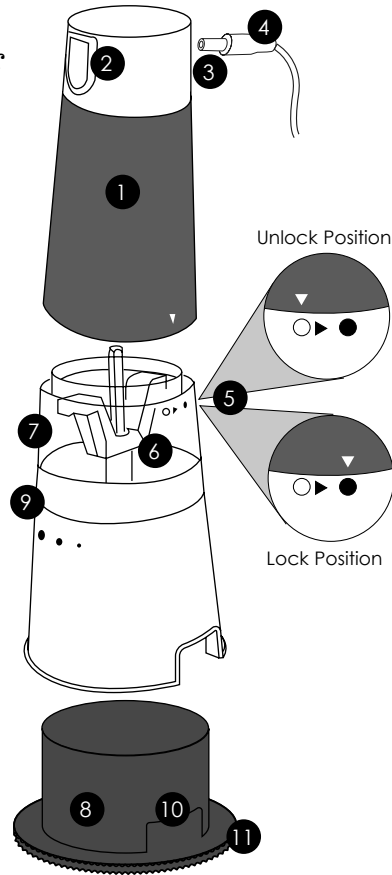
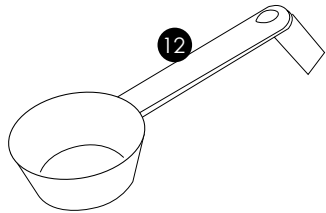

Before Using for the First Time

1. Unpack the Handheld Burr Grinder and remove all packaging materials.
2. Holding the base firmly in one hand, grasp the bottom ring with the other hand, then turn the bottom ring counter-clockwise until the tray door is closed. Pull the coffee tray out of the base.
3. Wipe the coffee tray with a damp cloth and make sure it is completely dry before using.
4. Replace coffee tray. Your Handheld Burr Grinder is now ready for use.

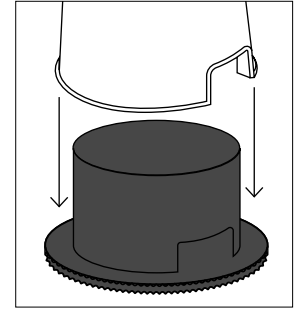

Perfect the Art of Coffee Grinding

Visit www.brim.coffee for easy to follow step-by-step video tutorials.

There's nothing better than the smell of fresh coffee being ground in the morning. It all starts with the beans, so don't compromise them. The brim Electric Handheld Burr Grinder's quick and convenient operation meets all of your daily grinding needs while ensuring that your coffee beans retain their flavor and aroma.

Grinding Coffee Beans

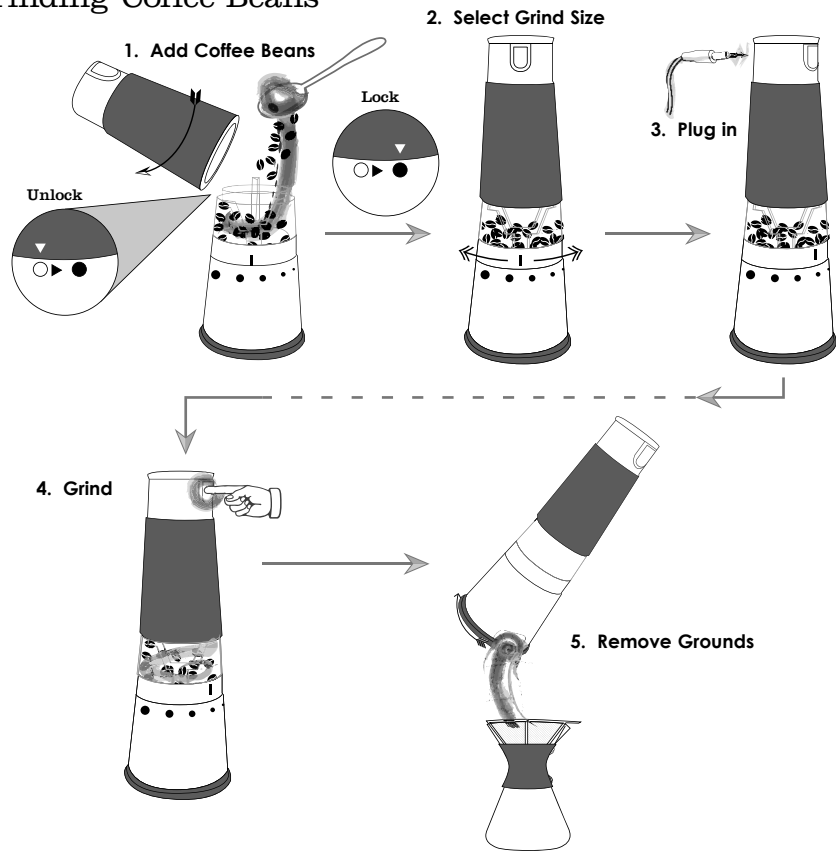

- 1. Add Coffee Beans:** Separate the coffee bean hopper from the upper housing. Grasp the coffee bean hopper firmly in one hand, and the silicone grip in the other. The unit is in the LOCKED position when the white arrow on the bottom of the upper housing is lined up with the solid circle. Turn the upper housing clockwise until the white arrow lines up with the open circle (UNLOCKED) and solid black arrow.

Lift the upper housing up and off to expose the coffee bean hopper. Carefully add up to 4 measuring scoops of whole roasted coffee beans to the coffee bean hopper. Lock the upper housing onto the grinding hopper. Line the white arrow on the bottom of the upper housing with the open circle. Turn the upper housing counter-clockwise until the white arrow lines up with the solid circle, indicating the unit is LOCKED

Holding the base firmly in one hand, grasp the bottom ring with the other hand and turn counter-clockwise until the grind tray door is in the closed position. **WARNING! If the tray door is not closed, ground coffee will be expelled.**

- 2. Select Grind Size:** Rotate the base to select the desired grind, from fine to coarse. Consult the Coffee Bean Grinding Chart for a description of grind sizes preferred for various coffee brewing techniques -- then adjust to your own taste.
- 3. Plug in:** Plug the power adapter into the power inlet. Plug the cord into a 120V AC electrical outlet. **NOTE: The power adapter must remain plugged into the unit and the wall for it to function. This grinder is non-rechargeable, and will not function when not plugged in.**
- 4. Grind:** Press the ON/OFF button. The Electric Handheld Burr Grinder will begin operation; ground coffee will drop into the ground coffee tray. Press the ON/OFF button again to turn the unit OFF.

CAUTION! The Electric Handheld Burr Grinder will remain in operation until the ON/OFF button is pressed to OFF. CAUTION! Overload protection: The Electric Handheld Burr Grinder is equipped with overload protection. If the appliance switches off during operation under extreme loads, proceed as follows; press the ON/OFF button immediately and disconnect the power. Allow the device to cool for Approximately 30 minutes.

- 5. Remove Grounds:** Holding the base firmly in one hand, grasp the bottom ring with the other hand and turn clockwise until the tray door is in the open position. Dispense ground coffee directly into any coffee maker filter basket. Store unused ground coffee in an airtight tray for future use. Clean the Electric Handheld Burr Grinder according to Care & Cleaning Instructions described in this instruction manual.

Coffee Bean Grinding Chart

Setting	Grind	Suggested Uses
1 - 2	Fine	Turkish, Mocha, Espresso, Aeropress
3 - 7	Drip / Medium	Automatic Drip/Filtered, Percolator, Pour Over
8 - 9	Coarse	French Press, Cold Brew

Hints for Best Results

- Fresh beans will yield the best flavor and aroma.
- Keep coffee beans in an airtight container in the freezer for up to 2 months.
NOTE: Coffee beans can be ground while frozen.
- A fine grind exposes more surface to the water and therefore a more rapid rate of extraction of flavor.
- A coarser grind, which exposes little surface, is appropriate for the longer brewing cycles.

Not Recommended

This Handheld Burr Grinder is NOT suitable for grinding herbs and spices.

- This Handheld Burr Grinder WILL NOT GRIND anything which is moist, gummy or extremely hard: ice, chocolate, whole nutmeg, candied ginger, etc.
- This Handheld Burr Grinder will NOT make pastes of any kind from seeds such as sunflower or sesame.
- Grinding cinnamon, cloves and nutmeg is not advised as the oils and hardness can cause the hopper to discolor or crack.
- Never add oils or liquids while grinding.
- Chopping, mincing or pureeing of soft foods is not recommended

User Maintenance Instructions

This appliance requires little maintenance. It contains no user-serviceable parts. Any servicing requiring disassembly other than cleaning must be performed by a qualified appliance repair technician.

Care & Cleaning Instructions

WARNING: DO NOT IMMERSE THE MOTOR BASE IN WATER. DO NOT PLACE HANDHELD BURR COFFEE GRINDER IN THE DISHWASHER!

1. Unplug the Electric Handheld Burr Grinder. Detach power cord from unit.
2. Holding the base firmly in one hand, grasp the bottom ring with the other hand, then turn the bottom ring counter-clockwise until the tray door is in the closed position. Pull the coffee tray out of the base. (See Figure2.) Wash in warm, soapy water, rinse and dry completely.
NOTE: The coffee tray is top rack dishwasher-safe.
3. Wipe the exterior with a damp cloth or paper towel to remove any excess ground coffee.
4. Make sure to clean completely after each use. Make sure to check the grinding hopper as coffee can collect there.

Storing Instructions

1. Unplug the Electric Handheld Burr Grinder from electrical outlet.
WARNING: Never store the Electric Handheld Burr Grinder while it is plugged in.
2. Store unit fully assembled in its box or in a clean, dry place.

Limited Two-Year Warranty

SENSIO Inc. hereby warrants that for a period of **TWO YEARS** from the date of purchase, this product will be free from mechanical defects in material and workmanship, and for 90 days in respect to non-mechanical parts. At its sole discretion, SENSIO Inc. will either repair or replace the product found to be defective, or issue a refund on the product during the warranty period.

Exclusions:

The warranty does not cover normal wear of parts or damage resulting from any of the following: negligent use of the product, use of improper voltage or current, improper routine maintenance, use contrary to the operating instructions, disassembly, repair, or alteration by anyone other than qualified SENSIO Inc. personnel. Also, the warranty does not cover Acts of God such as fire, floods, hurricanes, or tornadoes.

SENSIO Inc. shall not be liable for any incidental or consequential damages caused by the breach of any express or implied warranty. Apart from the extent prohibited by applicable law, any implied warranty of merchantability or

The warranty is only valid for the original retail purchaser from the date of initial retail purchase and is not transferable. Keep the original sales receipt, as proof of purchase is required to obtain warranty validation. Retail stores selling this product do not have the right to alter, modify, or in any way revise the terms and conditions of the warranty.

fitness for a particular purpose is limited in time to the duration of the warranty. Some states, provinces or jurisdictions do not allow the exclusion or limitation of incidental or consequential damages, or limitations on how long an implied warranty lasts, and therefore, the above exclusions or limitations may not apply to you. The warranty covers specific legal rights which may vary by state, province and/or jurisdiction.

How To Obtain Warranty Service:

You must contact Customer Service at our toll-free number: 1-866-832-4843. A Customer Service Representative will attempt to resolve warranty issues over the phone. If the Customer Service Representative is unable to resolve the problem, you will be provided with a case number and asked to return the product to SENSIO Inc. Attach a tag to the product that includes: your name, address, daytime contact telephone number, case number, and description of the problem.

Also, include a copy of the original sales receipt. Carefully package the tagged product with the sales receipt, and send it (with shipping and insurance prepaid) to SENSIO Inc.'s address. SENSIO Inc. shall bear no responsibility or liability for the returned product while in transit to SENSIO Inc.'s Customer Service Center.

brim®

since 1961

Perfect the art of coffee tasting.

For tips on how to use the **brim** tasting wheel visit www.brim.coffee

Coffee Origin/Name: _____

Roaster: _____ Roast Date _____

Variety: _____

Price: _____ Brew Date: _____

Notes: _____

Tasting Wheel

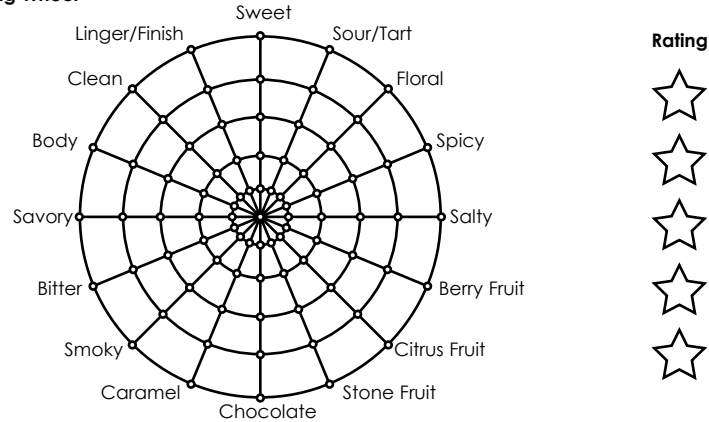

brim

Coffee Origin/Name: _____

Roaster: _____ Roast Date _____

Variety: _____

Price: _____ Brew Date: _____

Notes: _____

Tasting Wheel

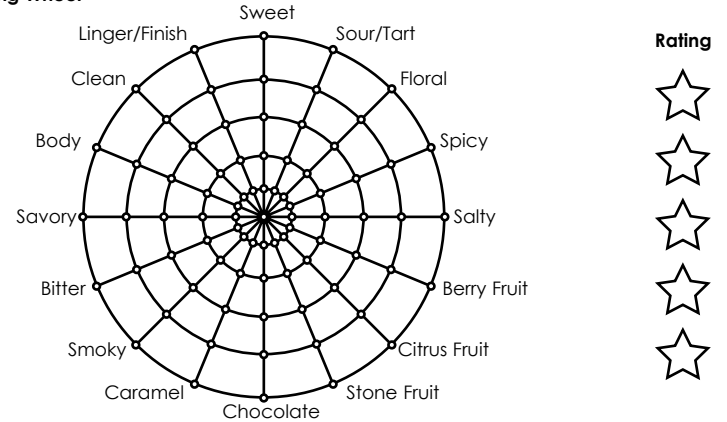

brim

Coffee Origin/Name: _____

Roaster: _____ Roast Date _____

Variety: _____

Price: _____ Brew Date: _____

Notes: _____

Tasting Wheel

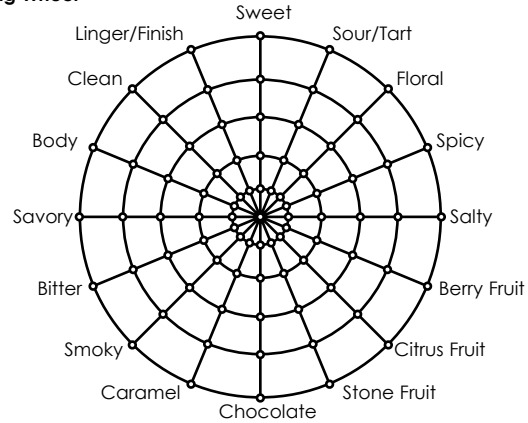

Rating



brim

Coffee Origin/Name: _____

Roaster: _____ Roast Date _____

Variety: _____

Price: _____ Brew Date: _____

Notes: _____

Tasting Wheel

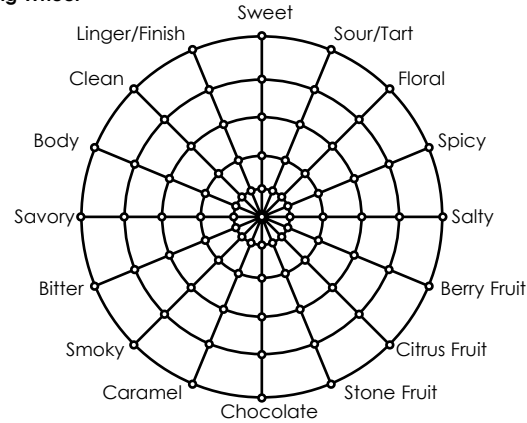

Rating



brim

Coffee Origin/Name: _____

Roaster: _____ Roast Date _____

Variety: _____

Price: _____ Brew Date: _____

Notes: _____

Tasting Wheel

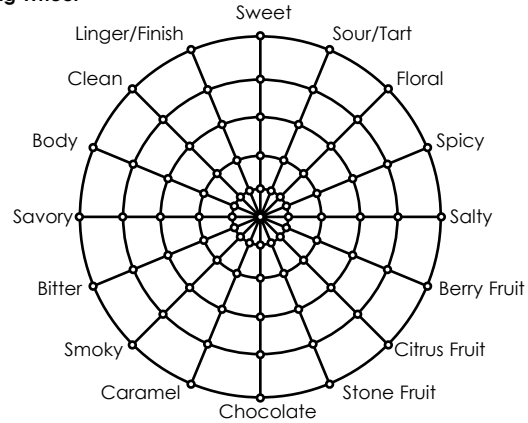

Rating



brim

Coffee Origin/Name: _____

Roaster: _____ Roast Date _____

Variety: _____

Price: _____ Brew Date: _____

Notes: _____

Tasting Wheel

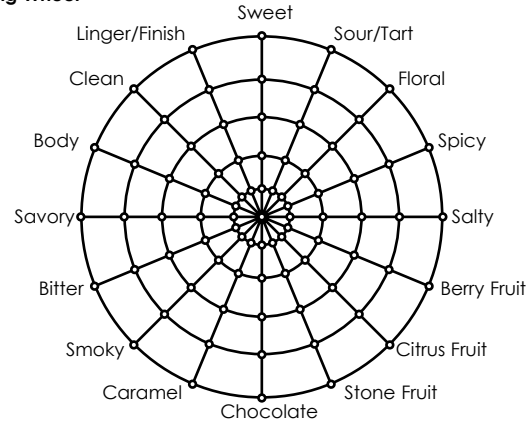

Rating



brim

Coffee Origin/Name: _____

Roaster: _____ Roast Date _____

Variety: _____

Price: _____ Brew Date: _____

Notes: _____

Tasting Wheel

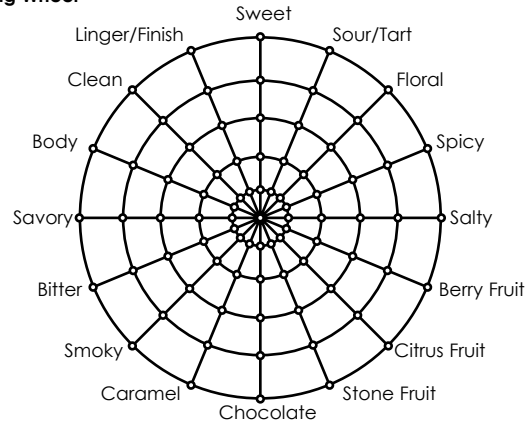

Rating



brim

Perfect the art of artisanal brewing
and discover great video tutorials, recipes,
tips & more by following us.

@brimcoffee      www.brim.coffee

Copyrights and Trademarks of BRIM Brands, LLC, including BRIM™ and BRIM®,
are used under license from BRIM Brands, LLC.

Sensio Inc., Montréal, Canada H3B 3X9

For customer service questions or comments 1-866-832-4843