

Pre-Lit Tree Instruction Sheet

READ AND FOLLOW ALL SAFETY INSTRUCTIONS

When using electrical products, basic precautions should always be followed including the following:

- The product is for indoor use only.
- To reduce the risk of fire, do not deliberately reposition either bulb or lampholder contact.
- To reduce the risk of overheating, replace burned out lamps promptly. This is an electrical product - not a toy! To avoid the risk of fire, burns, personal injury, and electric shock it should not be played with or placed where small children can reach it.
- Do not use seasonal products outdoors unless marked suitable for indoor and outdoor use. When products are used in outdoor applications, connect the product to a Ground Fault Circuit interrupting (GFCI) outlet. If one is not provided, contact a qualified electrician for proper installation.
- This seasonal use product is not intended for permanent installation or use.
- Do not mount or place near gas or electric heaters, fireplaces, candles or other similar sources of heat.
- Do not secure the wiring of the product with staples or nails, or place on sharp hooks or nails.
- Do not let lamps rest on the supply cord or on any wire.
- Unplug the product when leaving the house, when retiring for the night, or if left unattended.
- Do not use this product for other than its intended use.
- Do not hang ornaments or other objects from cord, wire, or light string.
- Do not close doors or windows on the product or extension cord as this may damage the wire insulation.
- Do not cover the product with a cloth, paper or any material not part of the product when in use.
- The product employs overload protection (fuse). A blown fuse indicates an overload or short circuit situation. If the fuse blows, unplug the product from the outlet. Also unplug any additional strings or products that may be attached to the product. Replace the fuse as per the user servicing instructions (follow product marking for proper fuse rating) and check the product. If the replacement fuse blows, a short circuit may be present and the product should be discarded.
- This product has a polarized plug (one blade is wider than the other) as a feature to reduce the risk of electric shock. This plug will fit in a polarized outlet only one way. If the plug does not fit fully in the outlet, reverse the plug. If it still does not fit, contact a qualified electrician. Do not use an extension cord unless plug can be fully inserted. Do not alter or replace the plug.

Read and follow all instructions that are on the product or provided with the product.

SAVE THESE INSTRUCTIONS

PRE-LIT TREE ASSEMBLY INSTRUCTIONS:

1. Follow the stand assembly instructions to set up the tree stand.

- a. Pull apart the legs of the stand so that they are X-shaped.
- b. Screw the eye bolts through the hole of metal tabs. Turn screws so they touch tree trunk. Stand tree up and straighten by adjusting screws in or out then tighten screws.

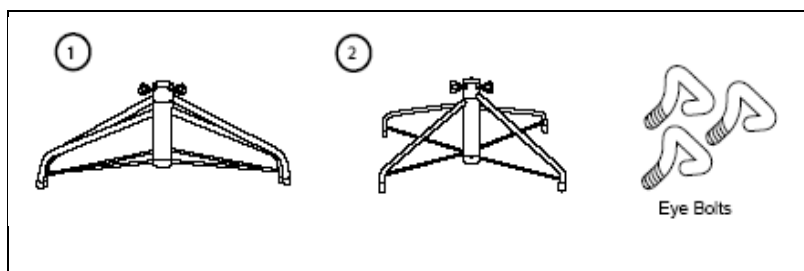

2. Assemble the tree according to below diagram.

-
- The diagram illustrates the assembly of a Christmas tree structure. It features a central vertical pole with a three-legged base. The tree is composed of three main sections, labeled A, B, and C, which are represented by orange outlines. Section A is the top, narrowest part, while section C is the bottom, widest part. A dashed vertical line runs through the center of the tree. Two circular callouts provide details: the top callout shows a small cylinder being placed on a pole, and the bottom callout shows a larger cylinder being placed on a pole. A string of lights is shown draped over the tree, with a plug at the bottom. To the right of the tree, there is a separate illustration of a leafy branch, showing a central stem with several smaller branches and leaves.
- Assembly tree and plug light strings**
- Shape the leaves**
- The diagram just for reference.
Tree layers may be from 2 (A.B) sections to 8 (A.B.C.D.E.F.G.H) sections.

Before using or reusing, inspect product carefully. Discard any products that have cut, damaged, or frayed wire insulation or cords, cracks in the lampholders, loose connections, or exposed copper wire.

Before storing the product, carefully remove the product from wherever it is placed to avoid any undue strain or stress on the product conductors, connections, and wires.

When not in use, store neatly in a cool, dry location protected from sunlight.

If your tree does not light up, please check the following.

1. Check that all plugs are properly connected.
2. Check fuse in extension cord plug. If the fuse is burned out, please replace it with spare fuse

enclosed.

3. Check wall outlet for power.
4. Check for loose, missing, or broken bulbs.

STORAGE:

Unplug extension cord from the wall outlet and remove all ornaments and decorations. (Except for decorations attached at factory.)

Unplug each section of extension cord, keep each stack of lights connected together. Gently lift off the top and middle sections, and remove the bottom section from the tree stand. Carefully replace the tree in its box and tape it shut. Store the box at a dry and cool place.

USER SERVICING INSTRUCTIONS:

BULB REPLACEMENT INSTRUCTIONS:

1. Make sure the light string is unplugged.
2. To unplug, grasp plug and remove from the receptacle or other outlet device. Do not unplug by pulling the cord.
3. Allow bulb to cool. To remove bulb, pull bulb out of socket. (see below diagram)

CAUTION: To reduce the risk of overheating, replace burned out lamps promptly. Use **2.5** volt, **0.425**watt lamps only.

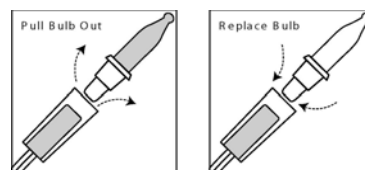

FUSE REPLACEMENT INSTRUCTIONS FOR EXTENSION CORD(For UL and CUL listed):

Risk of fire. Do not replace attachment plug. Contains a safety device (fuse) that should not be removed. Discard product if the attachment plug is damaged.

1. Unplug product from the receptacle or other outlet device. Do not unplug by pulling on cord.
2. Open fuse cover. Slide open fuse access cover on top of attachment plug toward blades.
3. Remove fuse carefully.
4. Risk of fire. Replace fuse with 5Amp, 125 Volt fuse (provided with this product).
5. Close fuse cover: slide closed the fuse access cover on top of attachment plug.

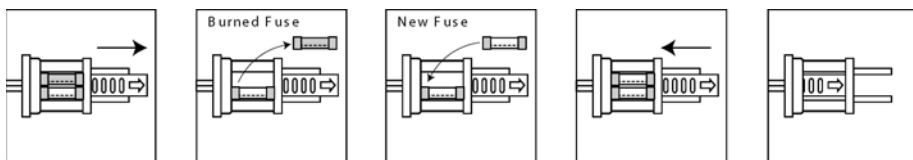

FUSE REPLACEMENT INSTRUCTIONS FOR EACH LIGHT STRING:(For UL and CUL listed light strings)

Risk of fire. Do not replace attachment plug. Contains a safety device (fuse) that should not be removed. Discard product if the attachment plug is damaged.

1. Unplug product from the receptacle or other outlet device. Do not unplug by pulling on cord.
2. Open fuse cover. Slide open fuse access cover on top of attachment plug toward blades.
3. Remove fuse carefully.
4. Risk of fire. Replace fuse with 3 Amp, 125 Volt fuse (provided with this product).
5. Close fuse cover: slide closed the fuse access cover on top of attachment plug.

MADE IN CHINA