

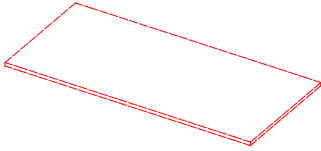

La Coupole Rec. Dining Table –Marble Top
Assembly Instructions

- Please note that top is sold separately.



(1) top - A

HARDWARE IS INCLUDED IN THIS PACKAGE:



(4) Long Bolt (Ø 5/16" x3/4") – a



(4) Spring Washer (Ø5/16") –b



(4) Flat Washer (Ø5/16"x19mm) –c



(1) Allen Wrench

After getting top, see here assembly instruction:

1. Attach **Top panel (A)** to the assembled base using blot (a), Spring washer (b) and Flat washer (c) with Allen wrench. Assembly is now complete. **See Fig.1**

Fig.1

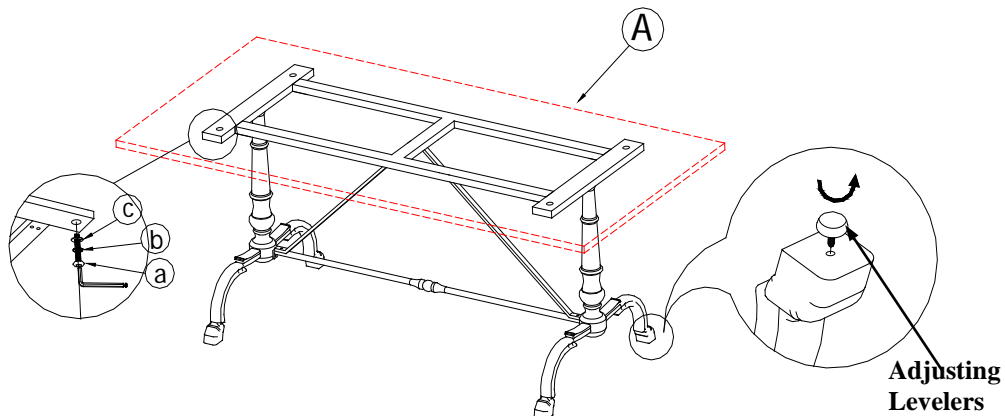

Adjusting Levelers:

Due to an uneven floor the furniture may not sit level due causing it to wobbles. If the piece wobbles, determine which corner does not touch the ground correctly. With two people follow these steps:

1. Carefully lift the item slightly to provide access to the levelers attached to the bottom. **See Fig.1**
2. Turn the levelers until adequate contact will be made with the floor. Gently set down the piece and check stability.
3. Repeat steps until furniture sits firmly on the ground.

Care Instructions:

- ☐ This item is intended for indoor use only. To clean, use a damp cloth; wipe spills immediately.
- ☐ Avoid the use of cleaners or abrasives as they may damage finish.
- ☐ The use of trivets and coasters on tabletop is recommended to protect the table top.
- ☐

Thank you for your purchase
Williams-Sonoma Home
Customer Service 1.888.922.4105
www.WSHome.com